

Abrasives and Cutting Tools

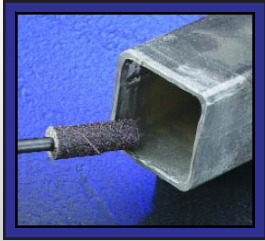

Quick Reference Catalog

Abrasives Index

Resin-Bonded Abrasives	Bench and Pedestal Wheels	Pg. 8
	Chop Saw Wheels, Type 1	Pg. 7
	Cup Stones, Type 11	Pg. 8
	Cut-Off Wheels, Type 1	Pg. 7
	Depressed Center Wheels, Type 27	Pg. 6
	Grinding Wheels, Type 27	Pg. 6
	High Speed Cut-Off Wheels, Type 1	Pg. 6
	Mounted Points	Pg. 8
Carbide Burrs	Carbide Burrs	Pg. 9
Coated Abrasives	Abrasive Sanding Sheets	Pg. 4
	Cartridge Rolls	Pg. 9
	EZ Strip Wheels	Pg. 4
	Fiber Discs	Pg. 1
	Flap Discs	Pg. 3
	Flap Wheels	Pg. 3
	Laminated Discs	Pg. 1
	Laminated Trim-Kut Discs	Pg. 1
	PSA Discs	Pg. 5
	Shop Rolls and Screen Rolls	Pg. 5
Non-Woven Abrasives	Heavy Duty Finishing Buffs	Pg. 2
	Interleaf Flap Wheels	Pg. 2
	Non-Woven Hand Pads	Pg. 4
	Scuff Ball	Pg. 2
	Surface Conditioning Discs	Pg. 2
Wire Brushes	Wire Wheel and Bristle Discs	Pg. 10

Cutting Tools Index

Annular Cutters	Annular Hole Cutters	Pg. 18
	Hole Saws	Pg. 17
	Rota Cutters	Pg. 18
Drill Sets	Bolt Extractor	Pg. 21
	Cobalt Jobbers Length	Pg. 20
	Jobber Length	Pg. 20
	Mechanics Length	Pg. 20
	Screw Machine	Pg. 20
	Silver and Deming	Pg. 20
	Tap and Drill	Pg. 21
Drills	Jobber Length	Pg. 11
	Mechanics Length	Pg. 11
	Reduced Shank	Pg. 12
	Screw Machine Length	Pg. 12
Masonry Tools	Core Bits	Pg. 19
	Masonry Drills and Sets	Pg. 20
	SDS-Max Hammer Drills	Pg. 19
	SDS-Plus Rotary Hammer Drills	Pg. 19
Specialty Tools	Bolt Remover Sets	Pg. 21
	Car Reamers	Pg. 14
	Cutting Tool Lubricant	Pg. 21
	Left-Hand Spiral Drills	Pg. 13
	Screw, Stud, and Pipe Extractors	Pg. 13
	Step Drills	Pg. 14
	Twin End Drills	Pg. 14
Taps & Dies	Bottoming Taps	Pg. 15
	Die Stocks	Pg. 16
	High Speed Steel Hex Dies	Pg. 15
	Plug Taps	Pg. 15
	Tap Extractors	Pg. 16
	Tap Sets	Pg. 15
	Tap Wrenches	Pg. 16
	Taper Taps	Pg. 15

EL-Cor offers a complete line of Abrasives and Cutting Tools from many manufacturers.

Due to limited space, not all products can be shown. Please call for more information regarding our complete line.

EL-Cor reserves the right to substitute products from various manufactureres with products of greater or equal quality, unless specified when ordering.

Resin Fibre Discs (Aluminum Oxide)

Size		Max RPM	24 Grit	36 Grit	60 Grit	80 Grit	100 Grit	120 Grit
Dia.	Bore							
4"	5/8"	15,300	CGW-48000	CGW-48001	CGW-48002	CGW-48005	CGW-48007	CGW-48008
4-1/2"	7/8"	13,300	CGW-48010	CGW-48011	CGW-48012	CGW-48015	CGW-48017	CGW-48018
5"		12,200	CGW-48020	CGW-48021	CGW-48022	CGW-48025	CGW-48027	CGW-48028
7"		8,600	CGW-48030	CGW-48031	CGW-48032	CGW-48035	CGW-48037	CGW-48038
9"		6,600	CGW-48040	CGW-48041	CGW-48042	CGW-48045	CGW-48047	CGW-48048



Standard Box Qty: 25

Resin Fibre Discs (Zirconia)

Size		Max RPM	16 Grit	24 Grit	36 Grit	60 Grit	80 Grit
Dia.	Bore						
4"	5/8"	15,300	CGW-48230	CGW-48231	CGW-48232	CGW-48235	CGW-48236
4-1/2"	7/8"	13,300	CGW-48100	CGW-48101	CGW-48102	CGW-48105	CGW-48106
5"		12,200	CGW-48110	CGW-48111	CGW-48112	CGW-48115	CGW-48116
7"		8,600	CGW-48120	CGW-48121	CGW-48122	CGW-48125	CGW-48126
9"		6,600		CGW-48141	CGW-48142	CGW-48145	CGW-48146



Standard Box Qty: 25

Laminated Discs (Aluminum Oxide w/ "R" Lock Quick Change Backing)

Size	Max RPM	36 Grit	40 Grit	50 Grit	60 Grit	80 Grit	100 Grit	120 Grit
1-1/2"	25,000	UA-50264	UA-50265	UA-50266	UA-50267	UA-50268	UA-50269	UA-50270
2"	25,000	UA-50271	UA-50272	UA-50273	UA-50274	UA-50275	UA-50276	UA-50277
3"	20,000	UA-50278	UA-50279	UA-50280	UA-50281	UA-50282	UA-50283	UA-50284

Standard Box Qty: 25, 50, 100

Trim-Kut Laminated Discs

Size	Max RPM	24 Grit	36 Grit	60 Grit	120 Grit
3"	21,000	GMX-24130200	GMX-24130300	GMX-24130500	GMX-24150800
4-1/2"	12,000		GMX-24145300	GMX-24145500	GMX-24145800
5"	13,000	GMX-24150200	GMX-24150300	GMX-24150500	GMX-24150800

This revolutionary abrasive is designed to grind and finish a wide variety of materials faster and cooler. A highly versatile grinding tool that requires no backing pad, and is easily trimmable to renew the cutting surface or reduce the diameter of the disc. Available in 3" and 5" for use on a drill or die grinder, and a 4-1/2" for use on an angle grinder. These durable discs can be used for grinding or sanding. Their unique one-piece design eliminates the need for backing pads. Each disc can be trimmed when the outside edge gets "loaded" to the point where it is not grinding effectively, just simply trim it off.

Trimming:

With the disc securely attached to the tool, run the disc at full speed and bring the plastic side of the disc at an angle of 5-10 degrees against a sharp edge of a secured piece of metal with constant light pressure.

Each box of 25 includes (1) 1/4" round mandrel to be used with disc.



Surface Conditioning Discs (Aluminum Oxide w/ "R" Lock Threaded Hub)

Size	Coarse Brown	Medium Brown	Fine Blue
1-1/2"	UA-77300	UA-77302	UA-77303
2"	UA-77306	UA-77308	UA-77309
3"	UA-77312	UA-77314	UA-77315
4"	UA-77318	UA-77320	UA-77321



Standard Box Qty: 25, 50, 100

Scuff Ball (Non-Woven Abrasive)

Size	Extra Coarse Tan	Coarse Green	General Purpose Maroon	Fine Gray
2-1/2"	GMX-57210	GMX-57240	GMX-57240	GMX-57230
4"	GMX-57410	GMX-57440	GMX-57420	GMX-57430

Made up of individual layers of non-woven material compressed into a ball, and mounted on a drive shaft for use on power tools. The non-woven abrasive is soft and adaptable to unusual shapes. Consistent finishing quality, the continuous exposure of new grit means consistency of the scuff ball does not change throughout its life. Resists clogging, and will not overheat.

Applications:

Ideal for doors & door jams

Polishes soft metals

Easily adapts to different angles.

Scuffs over rivets & screw heads

Scuff with no flat spots

Safely removes scales & oxidation

Fits around bar & inside tight areas



Heavy Duty Finishing Buffs

Size	Grit	1" x 1-1/4"	1-1/2" x 3/8"	2" x 1/2"
2-Ply	Medium	FB-100125M2	FB-150375M2	FB-200500M2
	Fine	FB-100125F2	FB-150375F2	FB-200500F2
3-Ply	Medium		FB-150375M3	FB-200500M3
	Fine		FB-150375F3	FB-200500F3
Threaded Mandrel	1/4" x 3"	FBM-250300 For use with all Finishing Buffs		



Standard Box Qty: 25, 50, 100

Interleaf Flap Wheels

Size	Max RPM	60 Grit Medium	80 Grit Medium	120 Grit Very Fine	180 Grit Very Fine
2" x 1"	11,000	CGW-36207	CGW-36208	CGW-36209	CGW-36210
3" x 1"	8,000	CGW-36211	CGW-36212	CGW-36213	CGW-36214
3" x 2"	8,000	CGW-36215	CGW-36216	CGW-36217	CGW-36218

Standard Box Qty: 10 (May be sold individually)

Alternating flaps of non-woven and coated abrasive materials for fast, uniform surface preparation and finishes.

Medium Grade: Easily clean, blend, and debur aluminum and stainless steel.

Very Fine Grade: For satin finishing on aluminum and stainless steel.

Spindle mount with 1/4" shank for quick and easy change.



Flap Wheels (Aluminum Oxide)

Size 1/4" Mandrel	60 Grit	80 Grit	120 Grit	180 Grit	240 Grit
1" x 3/4"	UA-70001	UA-70002	UA-70003	UA-70004	UA-70005
1" x 1"	UA-70010	UA-70011	UA-70012	UA-70013	UA-70014
1-1/2" x 1/2"	UA-70025	UA-70026	UA-70027	UA-70028	UA-70029
1-1/2" x 1"	UA-70040	UA-70041	UA-70042	UA-70043	UA-70044
2" x 1"	UA-70050	UA-70051	UA-70052	UA-70053	UA-70054
2-1/2" x 1/2"	UA-70060	UA-70061	UA-70062	UA-70063	UA-70064
2-1/2" x 1"	UA-70070	UA-70071	UA-70072	UA-70073	UA-70074
3" x 1/2"	UA-70080	UA-70081	UA-70082	UA-70083	UA-70084
3" x 3/4"	UA-70090	UA-70091	UA-70092	UA-70093	UA-70094
3" x 1"	UA-70100	UA-70101	UA-70102	UA-70103	UA-70104
3" x 2"	UA-70011	UA-70112	UA-70113		



Standard Box Qty: 10

Mini Flap Discs

Grit	Max RPM	2" Type R	3" Type R
36	24,000	CGW-30001	CGW-30011
40		CGW-30002	CGW-30012
60		CGW-30004	CGW-30014
80		CGW-30005	CGW-30015
120		CGW-30006	CGW-30016



Standard Box Qty: 10

Flap Discs (Zirconia)

Size	Grit	Regular Thickness		XL Thickness	
		T27	T29	T27	T29
4" x 5/8-11	36	CGW-42102	CGW-42121		CGW-42161
	40	CGW-42103	CGW-42122	CGW-42142	CGW-42162
	60	CGW-42104	CGW-42124	CGW-42144	CGW-42164
	80	CGW-42105	CGW-42125	CGW-42145	CGW-42165
	120	CGW-42106	CGW-42126	CGW-42146	

Size	Grit	Regular Thickness		XL Thickness	
		T27	T29	T27	T29
4-1/2" x 7/8	36	CGW-42301	CGW-42321	CGW-42341	CGW-42361
	40	CGW-42302	CGW-42322	CGW-42342	CGW-42362
	60	CGW-42304	CGW-42324	CGW-42344	CGW-42364
	80	CGW-42305	CGW-42325	CGW-42345	CGW-42365
	120	CGW-42306	CGW-42326	CGW-42346	CGW-42366

Size	Grit	Regular Thickness		XL Thickness	
		T27	T29	T27	T29
4-1/2" x 5/8-11	36	CGW-42311	CGW-42331	CGW-42351	CGW-42171
	40	CGW-42312	CGW-42332	CGW-42352	CGW-42372
	60	CGW-42314	CGW-42334	CGW-42354	CGW-42374
	80	CGW-42315	CGW-42335	CGW-42355	CGW-42375
	120	CGW-42316	CGW-42336	CGW-42356	CGW-42376



Standard Box Qty: 10

Recommended for aggressive use and heavy duty applications.
 Premium Zirconia Alumina with a poly/cotton backing provides added strength. XL discs have 60% more material.
Type 27: For working on flat grinding surfaces.
Type 29: For working on contoured and edge work.

EZ Strip Wheels

Color	4-1/2" x 7/8"	4-1/2" x 5/8"-11	7" x 7/8"	7" x 5/8"-11
Black	CGW-59200	CGW-59201	CGW-59202	CGW-59203
Red	CGW-59204	CGW-59205	CGW-59206	CGW-59207

Standard Box Qty: 10 (May be sold individually)

Non-woven wheels for cleaning welds and fast removal of rust, scaling, oxidation, paints, sealants, and other clogging materials.

Can be used on stainless steel, steel, aluminum, titanium, non-ferrous metals, fiber glass, stone, and wood.

Black EZ Strip: Clean and can provide satin finish.

Red EZ Strip: More rigid for faster working on angled and irregular surfaces.



Abrasive Sanding Sheets

Grit	DA-F	AW-D & AW-C*	Garnet
36	UA-84907		
40	UA-84908	UA-84211	
50	UA-84909	UA-84212	UA-84101
60	UA-84910	UA-84213	UA-84102
80	UA-84911	UA-84214	UA-84103
100	UA-84912	UA-84215	UA-84104
120	UA-84913	UA-84216	UA-84105
150	UA-84914	UA-84200*	
180	UA-84915	UA-84201*	UA-84107
220	UA-84916	UA-84202*	UA-84108
240	UA-84917	UA-84203*	
320	UA-84918	UA-84204*	

Standard Box Qty:

DA-F (36 Grit thru 80 Grit) 25 per box

DA-F (100 Grit thru 320 Grit) 50 per box

AW-D/AW-C (All Grits) 100 per box

Garnet (All Grits) Each Roll contains 100 pcs.

Each sheet measures 9" x 11" and is available in a wide assortment of grit sizes.

DA-F: Aluminum Oxide grain on a flexible cloth backing. Excellent for woodworking applications. Wet or dry use.

AW-D & AW-C: Highest quality industrial paper for extra durability on all applications. Wet or dry use.

Garnet: Natural garnet grain for dry use only. For use on soft woods.

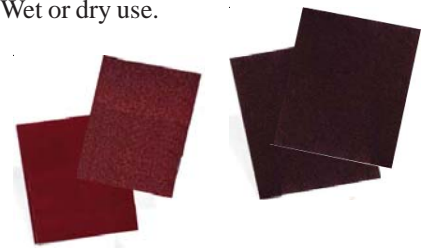

Non-Woven Had Pads (6" x 9")

Flexible nylon fibers with abrasive grain. This flexible non-woven product is designed for hand applications or can be used on oscillating sanders. Use dry or wet with water or solvents.

ALF-AP64561 General Purpose (Maroon): Excellent for cleaning and brightening

ALF-AP64560 Stripper (Green): Excellent for stripping paint and varnish.

ALF-AP64562 Ultra Fine (Gray): Excellent for sanding before and between finish coats.

ALF-AP64563 Light Duty (White): Excellent for light cleaning and polishing.



Standard Box Qty: 20 pads per box

Grit	1" (EA-F) Industrial Roll	1" (DA-F) Handy Roll	1-1/2" (EA-F) Industrial Roll	1-1/2" (DA-F) Handy Roll	2" (EA-F) Industrial Roll	2" (DA-F) Handy Roll
40	UA-80415	UA-80405	UA-80416	UA-80406	UA-80430	UA-80420
50	UA-80515	UA-80505	UA-80516	UA-80506	UA-80530	UA-80520
60	UA-80615	UA-80605	UA-80616	UA-80606	UA-80630	UA-80620
80	UA-80815	UA-80805	UA-80816	UA-80806	UA-80830	UA-80820
100	UA-81015	UA-81005	UA-81016	UA-81006	UA-81030	UA-81020
120	UA-81215	UA-81205	UA-81216	UA-81206	UA-81230	UA-81220
150	UA-81515	UA-81505	UA-81516	UA-81506	UA-81530	UA-81520
180	UA-81815	UA-81805	UA-81816	UA-81806	UA-81830	UA-81820
220	UA-82215	UA-82205	UA-81216	UA-82206	UA-82830	UA-82820
240	UA-82415	UA-82405	UA-82416	UA-82406	UA-82430	UA-82420
320	UA-83215	UA-83205	UA-83216	UA-83206	UA-83230	UA-83220

Resin over resin construction for a strong bond resistant to heat and moisture. Open coat structure prevents loading.

Industrial Rolls (EA-F): 50 yard rolls

Aluminum Oxide, for very high flexibility. High tensile strength for use on ferrous and/or non-ferrous metals, wood, and fiberglass.

Handy Rolls (DA-F): 50 yard rolls

Aluminum Oxide, for high flexibility. Medium tensile strength for use on ferrous and/or non-ferrous metals, wood, and fiberglass.



Screen Rolls

Grit	1-1/2" x 5 Yards	1-1/2" x 10 Yard	1-1/2" x 25 Yard
80	UA-84094	UA-84090	UA-84091
120	UA-84092	UA-84093	UA-84094
180	UA-84095	UA-84096	UA-84097



PSA Discs

Grit	Without Vacuum Holes	With Vacuum Holes
80	UA-36600	UA-36610
100	UA-36601	UA-36611
120	UA-36602	UA-36612
150	UA-36603	UA-36613
180	UA-36604	UA-36614
220	UA-36605	UA-36615
240	UA-36606	UA-36616
320	UA-36608	UA-36618

Standard Box Qty: 125 per box

Silicone carbide PSA disc rolls have a strong resin over resin bond construction which is resistant to heat and moisture.

Special sharp and durable aluminum oxide grain cuts fast and is long lasting. Perforated for easy disc tear away from roll. Open coat structure prevents loading, and each roll contains 125 discs.

Standard light weight, high flexibility PSA discs.

* Available in other sizes and materials upon request (Zirconium, Aluminum Oxide, Silicone Carbide).



Type 27 Cut-Off Wheels (Quickie Cut, Thin Reinforced)

Size	RPM	Spec.	Part No.
4 x .045 x 5/8	15,300	ZA60	CGW-45001
4-1/2 x .045 x 7/8	13,300	ZA60	CGW-45002
		A46	CGW-45004
5 x .045 x 7/8	12,250	ZA60	CGW-45005
6 x .045 x 7/8	12,700	ZA60	CGW-45007
7 x .045 x 7/8	8,600	ZA60	CGW-45008
9 x .045 x 7/8	6,600	ZA60	CGW-45047

Standard Box Qty: 25



ZA: Zirconia and Aluminum Oxide mixture

General purpose wheel. Zirconia grain allows for faster cutting and longer life. Excellent on steel and stainless.

A46: Aluminum Oxide mixture

Contains a non-loading bond. Good on aluminum.

Type 27 Depressed Center Wheels Type (1/4" Grinding Wheels)

Size	RPM	Metal A24N	Metal/Stainless ZA24T	Stainless/Metal WA24S	Aluminum A30N	Concrete/Stone C24R
4" x 1/4 x 3/8	15,300	CGW-35672	CGW-45036			
4" x 1/4 x 5/8		CGW-35699	CGW-35611		CGW-36106	CGW-37510
4-1/2" x 1/4 x 7/8	13,300	CGW-35622	CGW-35624	CGW-35673	CGW-36107	CGW-37520
4-1/2" x 1/4 x 5/8-11		CGW-35623	CGW-35625	CGW-35674	CGW-36108	CGW-37525
5" x 1/4 x 7/8	12,250	CGW-35627	CGW-37535	CGW-37543	CGW-36109	
5" x 1/4 x 5/8-11		CGW-35629	CGW-37530	CGW-37531	CGW-36110	
6" x 1/4 x 7/8	10,200	CGW-36231	CGW-45039	CGW-45048		
6" x 1/4 x 5/8-11		CGW-36232	CGW-45040	CGW-45049		
7" x 1/4 x 7/8	8,600	CGW-35642	CGW-35644	CGW-35677	CGW-36111	CGW-37545
7" x 1/4 x 5/8-11		CGW-35643	CGW-35645	CGW-35676	CGW-36112	CGW-37540
9" x 1/4 x 7/8	6,600	CGW-35656	CGW-35658	CGW-45081	CGW-36156	CGW-37555
9" x 1/4 x 5/8-11		CGW-35657	CGW-35659	CGW-45082	CGW-36157	CGW-37550

Standard Box Qty: 25 (Wheels with 5/8-11 Arbor 10 per box)

A24N: Aluminum Oxide Grain

Soft N-grade bond for fast stock removal.

ZA24T: Zirconia Aluminum Oxide Grain

Sharper, cuts faster, and lasts longer than aluminum oxide grain. Recommended for steel, cast iron, and stainless steel.

WA24S: White Aluminum Oxide Grain - Stainless Steel

Design for fast cutting of stainless steel, ferrous metals, and is contaminate-free.

A30N: Aluminum Oxide Grain - Aluminum

Soft N-grade bond for easy grinding of welding seams, sprues, and cast iron skin. Recommended for aluminum, copper, zinc, and other soft materials.

C24R: Silicone Carbide Grain - Concrete

R-grade bond for easy grinding of masonry, concrete, and stone.



Type 1 High Speed Reinforced Cut-Off Wheels (Aluminum Oxide)

Size	RPM	Spec.	Part No.
2" x 1/32 x 3/8	30,000	A60-R	CGW-45036
2" x 1/16 x 1/4		A60-R	CGW-35611
2" x 1/16 x 3/8		A60-R	CGW-35624
2" x 1/8 x 3/8		A24-R	CGW-35625
3" x 1/32 x 1/4	23,900	A60-R	CGW-35500
3" x 1/32 x 3/8		A60-R	CGW-35501
3" x 1/16 x 1/4		A36-R	CGW-35502
3" x 1/16 x 3/8		A36-R	CGW-35503
3" x 1/16 x 1/4		A60-R	CGW-45085
3" x 1/16 x 3/8		A60-R	CGW-45086
3" x 1/8 x 1/4		A24-R	CGW-35504
3" x 1/8 x 3/8		A24-R	CGW-35505
4" x 1/32 x 1/4		A60-R	CGW-35506
4" x 1/32 x 3/8		A60-R	CGW-35507
4" x 1/16 x 1/4	19,100	A36-R	CGW-35508
4" x 1/16 x 3/8		A36-R	CGW-35509
4" x 1/16 x 3/8		A60-R	CGW-45087
4" x 1/16 x 1/4		A60-R	CGW-45088
4" x 1/16 x 5/8		A36-R	CGW-35510
4" x 1/8 x 1/4		A24-R	CGW-35511
4" x 1/8 x 3/8		A24-R	CGW-35512



Standard Box Qty: 50

Type 1 Chop Saw Wheels (12" thru 16")

Size	RPM	A24-R General Purpose	A24-R Metal Decking	AC24-R Ductile Iron	C24-R Concrete/Stone	C16-U Asphalt
12" x 5/32 x 20mm	6,400	CGW-35587	CGW-36114	CGW-35590	CGW-35596	CGW-35593
12" x 5/32 x 1		CGW-35589	CGW-36115	CGW-35592	CGW-35998	CGW-35595
14" x 5/32 x 20mm	5,500	CGW-36158	CGW-36113	CGW-36160	CGW-35605	CGW-35603
14" x 5/32 x 1		CGW-36159	CGW-36126	CGW-36161	CGW-35606	CGW-35604
14" x 5/32 x 20mm Triple Reinforced		CGW-35599		CGW-35601		
14" x 5/32 x 1 Triple Reinforced		CGW-35600		CGW-35602		
16" x 5/32 x 20mm	4,800	CGW-36142		CGW-36144	CGW-36146	
16" x 5/32 x 1		CGW-36143		CGW-36145	CGW-36147	

Standard Box Qty: 10

A24R: Aluminum Oxide

General Purpose for metal, steel, and stainless. 14" are available in both double and triple reinforced.

A24T: Aluminum Oxide

For metal decking, and cable. Harder bond for more cuts on thinner metals. 14" are triple reinforced.

AC: Aluminum Oxide and Silicone Carbide Mixture

For use on ductile iron. 14" are available in both double and triple reinforced.

C16: Silicone Carbide

For use on asphalt and green concrete.

C24: Silicone Carbide

For use on concrete and stone.



Grade	Size				Max RPM	United Abrasive Part No.	CGW Part No.
	Bottom	Top	Width	Bore			
A16 General Purpose	4	3	2	5/8-11	9,050	UA-26000	CGW-49000
	5	4	2		7,250	UA-26010	CGW-49004
	6	4-3/4	2		6,050	UA-26020	CGW-49008
Z16 Zirconium	5	4	2		7,250	UA-26050	
	6	4-3/4	2		6,050	UA-26060	
C16 Concrete	4	3	2		9,050	UA-26001	CGW-49002
	5	4	2		7,250	UA-26011	CGW-49006
	6	4-3/4	2		6,050	UA-26021	CGW-35901
CA16 Concrete & Aluminum Oxide Combination	4	3	2		9,050	UA-26002	CGW-49003
	5	4	2		7,250	UA-26012	CGW-49007
	6	4-3/4	2		6,050	UA-26022	CGW-49014

*Cup Stones with metal backings are available upon request.



Bench and Pedestal Wheels

Straight vitrified wheels used for off-hand tool sharpening and grinding. Common settings for bench and pedestal grinders are in maintenance departments, tool & die shops, and metal fabrication shops.

Bench and Pedestal wheels are available in Aluminum Oxide, Green Silicone Carbide, and White Aluminum Oxide.

Available Sizes:

- 6 x 1/2 x 1 6 x 3/4 x 1 6 x 1 x 1 7 x 3/4 x 1
- 7 x 1 x 1 8 x 1 x 1-1/4 10 x 1 x 1-1/4 10 x 1-1/2 x 1-1/4
- 12 x 1 x 1-1/4 12 x 1-1/2 x 1-1/4 12 x 2 x 1-1/2 14 x 2 x 1-1/2
- 16 x 2 x 1-1/2 18 x 3 x 1-1/2



* Please call for part number information and details.

Mounted Points (Aluminum Oxide)

Size	Dimension	Shank	Part No.
A-1	7/8 x 2-1/2	1/4	CGW-35951
A-3	7/8 x 2-3/4		CGW-35953
A-4	1-1/4 x 1-1/4		CGW-35954
A-5	3/4 x 1-1/8		CGW-35955
A-11	7/8 x 2		CGW-35957
A-38	1 x 1		CGW-35975
B-44	7/32 x 3/8	1/8	CGW-35980
B-52	3/8 x 3/4		CGW-35985
B-132	3/8 x 1/2		CGW-36009
W-189	1/2 x 1	1/4	CGW-36042
W-220	1 x 1		CGW-36058
W-222	1 x 2		CGW-36060
W-236	1-1/2 x 1/2		CGW-36067

* Please call for other available sizes.



Standard Box Qty: 10, 25, 50, 100

Aluminum Oxide mounted points are ideal in tool and die shops. Semi-friable pink PA abrasive is used to produce sharp, consistent cutting action.

Great for deburring, tool sharpening, finishing cavities, removal of mold marks, and parting lines.

Shape		Available Sizes									
		1/8	3/16	1/4	5/16	3/8	7/16	1/2	5/8	3/4	1
Cylindrical	SA	X	X	X	X	X	X		X	X	X
Cylindrical End Cut	SB	X	X	X	X	X	X		X	X	X
Radius End	SC	X	X	X	X	X	X		X	X	
Round Tree	SF			X		X	X	X	X	X	
Pointed Tree	SG			X	X	X		X	X	X	
Oval Shape	SE		X	X		X		X	X	X	
Ball Shape	SD	X	X	X	X	X	X	X	X	X	X
Cone Shape	SM			X		X		X	X		
14° Tapered	SL			X	X	X		X	X	X	
Flame Shape	SH			X	X			X	X	X	
Inverted Cone	SN			X		X		X	X	X	

Made from high performance, industrial grade carbide to give long life and exceptional performance in the most demanding applications. Each burr has "Double-Cut" flutes with a 1/4" shank. Please call for other available Carbide Burrs.

Diameter	1/8"	3/16"	1/4"	5/16"	3/8"	7/16"	1/2"	5/8"	3/4"	1"
Burr Number	12	14	1	2	3	4	5	6	7	9

Example: SA-3 = Cylindrical Shape Carbide Burr, 1/4" shank x 3/8" diameter.

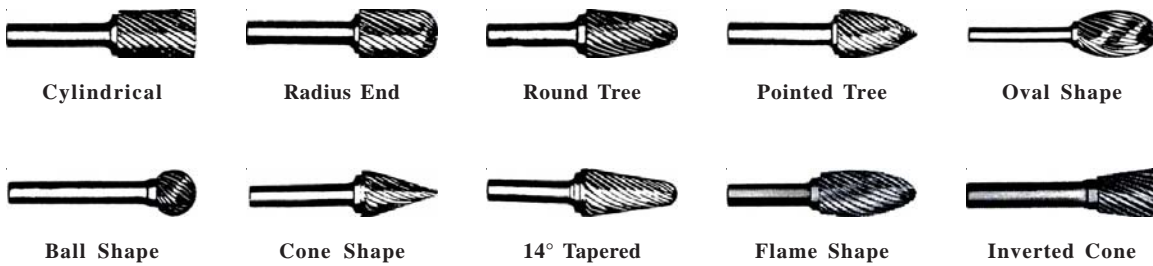

Cartridge Rolls (Aluminum Oxide)

Size	Grit	Straight (ASR)	Tapered (ATR)
1/4" x 1" x 1/8"	40	75001	
	80	75003	
	120	75005	
1/4" x 1-1/2" x 1/8"	40	75007	
	80	75009	
	120	75011	
1/4" x 2" x 1/8"	40	75013	
	80	75015	
	120	75017	
3/8" x 1" x 1/8"	40	75019	75101
	80	75021	75103
	120	75023	75105
3/8" x 1-1/2" x 1/8"	40	75025	75107
	80	75027	75109
	120	75029	75111
3/8" x 2" x 1/8"	40	75031	
	80	75033	
	120	75035	

Size Base x L x Arbor	Grit	Straight (ASR)	Tapered (ATR)
1/2" x 1" x 1/8"	40	75037	75113
	80	75039	75115
	120	75041	75117
1/2" x 1-1/2" x 1/8"	40	75043	75119
	80	75045	75121
	120	75047	75123
1/2" x 2" x 1/8"	40	75049	
	80	75051	
	120	75053	
3/4" x 1" x 3/16"	40	75055	
	80	75057	
	120	75059	
3/4" x 1-1/2" x 3/16"	40	75061	75137
	80	75063	75139
	120	75065	75141
3/4" x 2" x 1/4"	40	75067	
	80	75069	
	120	75071	

Cartridge Rolls come in standard packages of
 10
 25
 50
 100



Standard Box Qty: 10, 25, 50, 100

Brushes are available in a variety of wire types. The proper brush for the application should be selected based on the characteristics of the brush, including wire type.

Knot Wire Brushes:

Provide high impact action and offer low to medium flexibility through the use of twisted wire tufts for heavy duty applications.

Crimped Wire Brushes:

General purpose brushes that provide higher flexibility and cleaning action through the use of flexible wire points. They offer a wider work face than knot style and are ideal for light applications such as rust or paint removal.



Regular
Twist Knot



Stringer
Bead Knot



Crimped



Available Wire Brushes:

- Bench Wire Wheels
- Large Cup Brushes
- Small Cup Brushes
- Knot and Crimped Wire Wheels
- Pipeline Brushes
- End Brushes
- Scratch Brushes

*Please call for product details and part numbers.

3M Roloc Bristle Discs

Grit	Color	1"	2"	3"
50	Green	TM-18698	TM-18730	TM-18734
80	Yellow	TM-18706	TM-18732	TM-18736
120	White	TM-18710	TM-18733	TM-18737

Standard Box Qty: 10



Backing Pads

We offer Backing Pads and Backing Pad accessories for all of the following types of abrasives:

- Resin Fiber Discs
- Laminated and Surface Conditioning Discs
- PSA Discs
- Sandpaper

* Please call for more product information.



Also Available: A full line of products from the following manufactures

- United Abrasives and SAIT
- Camel Grinding Wheels (CGW)
- 3M
- Other various manufactures

* EL-Cor Industries reserves the right to substitute brand names if not specified by customer.

135° split point for fast penetration and accurate starting without a center punch.

Precision ground point, flutes, body, clearance, and drill diameter for the ultimate in accuracy and performance. Recommended for use in work hardening grades of stainless steel and other hard metal drilling applications.

* Sizes smaller than #52 have non-split points.

Fractional Sizes: 1/16" thru 3/4" **Wire Sizes:** #1 thru #60
Letter Sizes: A thru Z **Metric Sizes:** .070mm thru 13.00mm (Type 170AG)



Diameter	Part No.
1/16	CTD-05580
5/64	CTD-05590
3/32	CTD-05600
7/64	CTD-05610
1/8	CTD-05620
9/64	CTD-05360
5/32	CTD-05640
11/64	CTD-05650
3/16	CTD-05660
13/64	CTD-05670

Diameter	Part No.
7/32	CTD-05680
15/64	CTD-05690
1/4	CTD-05700
17/64	CTD-05710
9/32	CTD-05720
19/64	CTD-05730
5/16	CTD-05740
21/64	CTD-05750
11/32	CTD-05760
23/64	CTD-05770

Diameter	Part No.
3/8	CTD-05780
25/64	CTD-05790
13/32	CTD-05800
27/64	CTD-05810
7/16	CTD-05820
29/64	CTD-05830
15/32	CTD-05840
31/64	CTD-05850
1/2	CTD-05860
33/64	CTD-22210

Diameter	Part No.
17/32	CTD-22220
35/64	CTD-22230
9/16	CTD-22240
37/64	CTD-22250
19/32	CTD-22260
39/64	CTD-22270
5/8	CTD-22280
41/64	CTD-22290
21/32	CTD-22300
43/64	CTD-22310

Diameter	Part No.
11/16	CTD-22320
45/64	CTD-22330
23/32	CTD-22340
47/64	CTD-22350
3/4	CTD-22360

Standard Package Qty: 1/16" thru 9/32" (12), 19/64" thru 1/2" (6), 33/64" thru 3/4" (1) (All Drill Bits may be sold individually)

Jobbers Length Drills, 3/8" Shank (Type 128AG)

Diameter	Part No.
25/64	CTD-59200
13/32	CTD-59210
27/64	CTD-59220
7/16	CTD-59230
29/64	CTD-59240

Diameter	Part No.
15/32	CTD-59250
31/64	CTD-59260
1/2	CTD-59260
17/32	CTD-59270
9/16	CTD-59280

Diameter	Part No.
19/32	CTD-59300
5/8	CTD-59310



Mechanics Length Drills (Type 175AG)

135° split point for fast penetration and accurate starting without a center punch.

Precision ground point, flutes, body, clearance, and drill diameter for the ultimate in accuracy and performance. Especially designed for hand held drills. Flats on shank give positive chuck grip 3/16" and larger.



Diameter	Part No.
1/16	CTD-22860
5/64	CTD-22870
3/32	CTD-22880
7/64	CTD-86950
1/8	CTD-86960
9/64	CTD-86970
5/32	CTD-86980
11/64	CTD-86990
3/16	CTD-87000
13/64	CTD-87010

Diameter	Part No.
7/32	CTD-87020
15/64	CTD-87030
1/4	CTD-87040
17/64	CTD-87050
9/32	CTD-87060
19/64	CTD-87070
5/16	CTD-87080
21/64	CTD-87090
11/32	CTD-87100
23/64	CTD-87110

Diameter	Part No.
3/8	CTD-87120
25/64	CTD-87130
13/32	CTD-87140
27/64	CTD-87150
7/16	CTD-87160
29/64	CTD-87170
15/32	CTD-87180
31/64	CTD-87190
1/2	CTD-87200

Standard Package Qty: 1/16" thru 9/32" (12), 19/64" thru 1/2" (6) (All Drill Bits may be sold individually)

Mechanics Length Drills, 3/8" Shank (Type 178AG)

Diameter	Part No.
13/32	CTD-81560
27/64	CTD-81570
7/16	CTD-81580
29/64	CTD-81590

Diameter	Part No.
15/32	CTD-81600
31/64	CTD-81610
1/2	CTD-81620



Screw Machine Length Drills (Type 135AG)

135° split point gold surface treated.

Heavy duty construction requires no center punch. Recommended hard metal drilling applications.

Fractional Sizes: 1/16" thru 3/4" **Wire Sizes:** #1 thru #60

Letter Sizes: A thru Z



Diameter	Part No.
1/16	CTD-87710
5/64	CTD-87720
3/32	CTD-87730
7/64	CTD-87740
1/8	CTD-87750
9/64	CTD-87760
5/32	CTD-87770
11/64	CTD-87780
3/16	CTD-87790
13/64	CTD-87800

Diameter	Part No.
7/32	CTD-87810
15/64	CTD-87820
1/4	CTD-87830
17/64	CTD-87840
9/32	CTD-87580
19/64	CTD-87860
5/16	CTD-87870
21/64	CTD-87880
11/32	CTD-87890
23/64	CTD-87900

Diameter	Part No.
3/8	CTD-87910
25/64	CTD-87920
13/32	CTD-87930
27/64	CTD-87940
7/16	CTD-87950
29/64	CTD-87960
15/32	CTD-87970
31/64	CTD-87980
1/2	CTD-87990
33/64	CTD-88000

Diameter	Part No.
17/32	CTD-88010
35/64	CTD-88020
9/16	CTD-88030
37/64	CTD-88040
19/32	CTD-88050
39/64	CTD-88060
5/8	CTD-88070
41/64	CTD-88080
21/32	CTD-88090
43/64	CTD-89210

Diameter	Part No.
11/16	CTD-89220
45/64	CTD-89230
23/32	CTD-89240
47/64	CTD-89250
3/4	CTD-89260

Standard Package Qty: 1/16" thru 9/32" (12), 19/64" thru 1/2" (6), 33/64" thru 3/4" (1) (All Drill Bits may be sold individually)

Screw Machine Length Drills, 1/4" Shank (Type 125AG)

Diameter	Part No.
17/64	CTD-22410
9/32	CTD-22420
19/64	CTD-22430
5/16	CTD-22440
21/64	CTD-22450

Diameter	Part No.
11/32	CTD-22460
23/64	CTD-22470
3/8	CTD-22490
25*64	CTD-22490
13/32	CTD-22500

Diameter	Part No.
27/64	CTD-22510
7/16	CTD-22520
29/64	CTD-22530
15/32	CTD-22540
31/64	CTD-22550
1/2	CTD-22560



Reduced Shank Drills, 1/2" Shank (Type 130AG)

135° split point gold surface treated.

Heavy duty construction requires no center punch. Over 1" have 118° split point.



Diameter	Part No.
33/64	CTD-29550
17/32	CTD-29560
35/64	CTD-29570
9/16	CTD-29580
37/64	CTD-29590
19/32	CTD-29600
39/64	CTD-29610
5/8	CTD-29620
41/64	CTD-29630
21/32	CTD-29640

Diameter	Part No.
43/64	CTD-29650
11/16	CTD-29660
45/64	CTD-29670
23/32	CTD-29680
47/64	CTD-29690
3/4	CTD-29700
49/64	CTD-29710
25/32	CTD-29720
51/64	CTD-29730
13/16	CTD-29740

Diameter	Part No.
53/64	CTD-29750
27/32	CTD-29760
55/64	CTD-29770
7/8	CTD-29780
57/64	CTD-29790
29/32	CTD-29800
59/64	CTD-29810
15/16	CTD-29820
64/64	CTD-29830
31/32	CTD-29840

Diameter	Part No.
63/64	CTD-29850
1	CTD-29860
1-1/32	CTD-29870
1-1/16	CTD-29880
1-3/32	CTD-29890
1-1/8	CTD-29900
1-5/32	CTD-29910
1-3/16	CTD-29920
1-7/32	CTD-29930
1-1/4	CTD-29940

Diameter	Part No.
1-5/16	CTD-29950
1-3/8	CTD-29960
1-7/16	CTD-29970
1-1/2	CTD-29980

Standard Package Qty: 6 (All Drill Bits may be sold individually)

135° split point gold surface treated.

Heavy duty construction requires no center punch. For use with 3/4" chucks.



Diameter	Part No.
13/16	CTD-29741
7/8	CTD-29781
15/16	CTD-29821
1	CTD-29861

Diameter	Part No.
1-1/8	CTD-29901
1-1/4	CTD-29941
1-3/8	CTD-29961
1-1/2	CTD-29981

Standard Package Qty: 1

Left Hand Spiral Drills (Type 190AL)

135° split point gold surface treated.

Heavy duty construction requires no center punch. Designed to eliminate the need for screw or bolt extractor. Left hand spiral drill may loosen the bolt stud while drilling a hole for use of the screw and bolt extractor.



Diameter	Part No.
1/16	CTD-92430
5/64	CTD-23150
3/32	CTD-89290
7/64	CTD-23160
1/8	CTD-92440
9/64	CTD-92441
5/32	CTD-23170
11/64	CTD-92442
3/16	CTD-92450
13/64	CTD-92443

Diameter	Part No.
7/32	CTD-92444
15/64	CTD-92451
1/4	CTD-92460
17/64	CTD-92452
9/32	CTD-92453
19/64	CTD-23180
5/16	CTD-92470
21/64	CTD-92471
11/32	CTD-92472
23/64	CTD-92473

Diameter	Part No.
3/8	CTD-92480
25/64	CTD-92481
13/32	CTD-92482
27/64	CTD-92483
7/16	CTD-92490
29/64	CTD-92491
15/32	CTD-92492
31/64	CTD-92493
1/2	CTD-92500

Standard Package Qty: 1/16" thru 9/32" (6), 19/64" thru 1/2" (3) (All Drill Bits may be sold individually)

Screw, Stud, & Pipe Extractors (Type 420 & 421AG)

Screw & Pipe Spiral Style - Type 420

Forged hi-carbon steel. Broken piece is extracted without damage to threads.

Studout Square Style - Type 421AG

Forged hi-carbon steel with gold finish. The square shape of these extractors gives the tools the ability to remove broken bolts, screws, and pipes with minimum damage.



Screw Extractor No.	To Remove Diameter of Screw	Drill Size	Part No. Type 420
EX-1	3/32 to 5/32	5/64	CTD-57100
EX-2	5/32 to 7/32	7/64	CTD-57110
EX-3	7/32 to 9/32	5/32	CTD-57120
EX-4	9/32 to 3/8 and 1/8 Pipe	1/4	CTD-57130
EX-5	3/8 to 5/8 and 1/4 Pipe	17/64	CTD-57140
EX-6	5/8 to 7/8 and 3/8 Pipe	13/32	CTD-57150
EX-7	7/8 to 1-1/8 and 1/2 Pipe	17/32	CTD-57160
EX-8	1-1/8 to 1-3/8 and 3/4 Pipe	13/16	CTD-57170
EX-9	1-3/8 up and 1" Pipe	1-1/8	CTD-57180

Screw Extractor No.	To Remove Diameter of Screw	Drill Size	Part No. Type 421AG
E-1	3/16 to 9/32	1/8	CTD-70760
E-2	9/32 to 11/32	3/16	CTD-70770
E-3	11/32 to 1/2	1/4	CTD-70780
E-4	1/2 to 3/4	5/16	CTD-70800
E-5	5/8 to 7/8	3/8	CTD-70810
E-6	7/8 to 1"	1/2	CTD-70820
E-7	1" to 1-1/4	9/16	CTD-70830
E-8	1-1/8 to 1-1/2	5/8	CTD-70860
E-9	1-1/4 to 1-3/4	11/16	CTD-70870

Standard Package Qty: E/EX-1 thru E/EX-5 (5), E/EX-6 thru E/EX-6 (1) (All Extractors may be sold individually)

Gold surface treated designed for the reaming of structural steel plate commonly found in truck frames, rail cars, bridges, and pressure vessels. Each reamer has 3 flats on the shank and are made of hi-tungsten tool steel.

For use only to enlarge previously formed or drilled holes. All tools are constructed with left-hand spiral and right hand cut. Left-hand spiral eliminates the tendency of the reamer to hog into holes.



Diameter	Min. Starting Hole Size	Shank Diameter	Type 50AG Standard Flute	Type 51AG Fast Spiral
3/8	5/16	3/8	CTD-06390	CTD-06391
1/2	3/8	1/2	CTD-06400	CTD-06401
9/16	7/16		CTD-06410	CTD-06411
5/8	7/16		CTD-06420	CTD-06421
11/16	15/32		CTD-06430	CTD-06431
3/4	1/2		CTD-06440	CTD-06441
13/16	35/64		CTD-06450	CTD-06451
7/8	19/32		CTD-06460	CTD-06461
15/16	5/8		CTD-06470	CTD-06471
1"	7/8		CTD-06480	CTD-06481
1-1/4"	1"		CTD-06484	CTD-06482

Standard Package Qty: 1

Ultra Bit Step Drills (Type 78AG)

Ultra Bit multi-diameter step drills have 3 flats on shank. Special moly alloy steel has gold surface treatment.

Dual flute construction drills clean accurate holes in thin materials. For use with all thin metals, rigid plastics, and wood with a thickness equal to or less then step thickness. When drilling steel with 1/8" or greater thickness, a starter hole of the smallest step diameter will help.

* Part number CTD-00711 has extra length steps at 7/8, 1-1/8, & 1-3/8 for conduit knock-outs.



Size	Number of Hole Sizes	Range	Shank Size	Step Increments	Step Thickness	Part No.
1/8-1/2	13	1/8 to 1/2	1/4	1/32	1/8	CTD-00700
3/16A	6	3/16 to 1/2		1/16	3/8	CTD-00701
3/16B	12	3/16 to 7/8	3/8	1/16	1/8	CTD-00702
1/4-3/4	9	1/4 to 3/4		1/16	5/32	CTD-00703
9/16-1	8	9/16 to 1"		1/16	5/32	CTD-00704
13/16	10	13/16 to 1-3/8	1/2	1/32	5/32	CTD-00710
1/4 x 0	10	1/4 to 1-3/8	3/8	1/8	* See Note	CTD-00711

Standard Package Qty: 1

Twin End Drills (Type 140-G)

135° split point Twin End Drills have gold surface treatment for fast penetration and accurate drilling without a center punch. Extra rugged uncleared construction gives superior performance and less breakage.



Size	Part No.
3/32	CTD-95090
7/64	CTD-95080
1/8	CTD-95980
9/64	CTD-95070

Size	Part No.
5/32	CTD-95060
3/16	CTD-95050
7/32	CTD-95040
1/4	CTD-95030

Standard Package Qty: 12(All Drill Bits may be sold individually)

Special hi-tungsten and hi-molybdenum tool steels, gold surface treated for maximum lubricity. For general use in production tapping or hand operations. Precision ground threads for the ultimate in accuracy and performance.

Spiral Point Plug Style Tap (20AG): Drives chips ahead of the tap, for higher speeds and faster cutting with less torque.

Taper Style Tap (23AG): Start the thread square with workpiece, ideal for blind and through holes.

Plug Style Tap (24AG): Generally used in through holes.

Bottoming Style Tap (25AG): Generates the thread to the bottom of blind holes.

Tap Sets (26AG): Includes one each of the same size: Type 23, 24, & 25AG taps.



Type 20AG



Type 23AG



Type 24AG



Type 25AG

Hexagon Dies (27AG): Used for threading rods, bolts, studs, and other pieces requiring external threads.



Type 23AG

* All Taps and Dies are available in METRIC sizes. (Please call for product information)

Size	Spiral Point Tap Type 20AG	Taper Tap Type 23AG	Plug Style Tap Type 24AG	Bottoming Tap Type 25AG	Tap Sets Type 26AG	Hexagon Dies Type 27AG
6-32	CTD-60220	CTD-60750	CTD-60751	CTD-60752	CTD-60753	CTD-61010
6-40	CTD-60230	CTD-60760	CTD-60761	CTD-60762	CTD-60763	
8-32	CTD-60240	CTD-60770	CTD-60771	CTD-60772	CTD-60773	CTD-61020
8-36	CTD-60250	CTD-60780	CTD-60781	CTD-60782	CTD-60783	
10-24	CTD-60260	CTD-60790	CTD-60791	CTD-60792	CTD-60793	CTD-61030
10-32	CTD-60270	CTD-60800	CTD-60801	CTD-60802	CTD-60803	CTD-61040
12-24	CTD-60280	CTD-60810	CTD-60811	CTD-60812	CTD-60813	CTD-61050
12-28	CTD-60290	CTD-60820	CTD-60821	CTD-60822	CTD-60823	
1/4-20	CTD-60320	CTD-60830	CTD-60831	CTD-60832	CTD-60833	CTD-61060
1/4-28	CTD-60330	CTD-60840	CTD-60841	CTD-60842	CTD-60843	CTD-61070
5/16-18	CTD-60340	CTD-60850	CTD-60851	CTD-60852	CTD-60853	CTD-61080
5/16-24	CTD-60350	CTD-60860	CTD-60861	CTD-60862	CTD-60863	CTD-61090
3/8-16	CTD-60360	CTD-60870	CTD-60871	CTD-60872	CTD-60873	CTD-61100
3/8-24	CTD-60370	CTD-60880	CTD-60881	CTD-60882	CTD-60883	CTD-61110
7/16-14	CTD-60380	CTD-60890	CTD-60891	CTD-60892	CTD-60893	CTD-61120
7/16-20	CTD-60390	CTD-60900	CTD-60901	CTD-60902	CTD-60903	CTD-61130
1/2-13	CTD-60400	CTD-60910	CTD-60911	CTD-60912	CTD-60913	CTD-61140
1/2-20	CTD-60410	CTD-90920	CTD-90921	CTD-90922	CTD-60923	CTD-61150
9/16-12		CTD-60950	CTD-60951	CTD-60952	CTD-60953	CTD-61160
9/16-18		CTD-60960	CTD-60961	CTD-60962	CTD-60963	CTD-61170
5/8-11	CTD-60420	CTD-60970	CTD-60971	CTD-60972	CTD-60973	CTD-61180
5/8-18	CTD-60430	CTD-60980	CTD-60981	CTD-60982	CTD-60983	CTD-61190
3/4-10	CTD-60440	CTD-60990	CTD-60991	CTD-60992	CTD-60993	CTD-61200
3/4-16	CTD-60450	CTD-61400	CTD-61401	CTD-61402	CTD-61403	CTD-61203

Standard Package Qty: 6-32 thru 1/2"-20 (3), 9/16"-12 thru 3/4"-16 (1) (All Taps & Dies may be sold individually)



Tap Extractors

Tap Size	4-Flute	3-Flute	2-Flute
#4		ALF-TE10043	ALF-TE10042
#5		ALF-TE10053	ALF-TE10052
#6	ALF-TE10064	ALF-TE10063	ALF-TE10062
#8	ALF-TE10084	ALF-TE10083	ALF-TE10082
#10	ALF-TE10104	ALF-TE10103	ALF-TE10102
#12	ALF-TE10124	ALF-TE10123	ALF-TE10122
1/4	ALF-TE10254	ALF-TE10253	ALF-TE10252
5/16	ALF-TE10314	ALF-TE10313	ALF-TE10312
3/8	ALF-TE10374	ALF-TE10373	ALF-TE10372
7/16	ALF-TE10434	ALF-TE10433	ALF-TE10432
1/2	ALF-TE10504	ALF-TE10503	ALF-TE10502
9/16	ALF-TE10564	ALF-TE10563	
5/8	ALF-TE10624	ALF-TE10623	
11/16	ALF-TE10684		
3/4	ALF-TE10754	ALF-TE10753	
7/8	ALF-TE10874	ALF-TE10873	
1"	ALF-TE10004	ALF-TE10003	

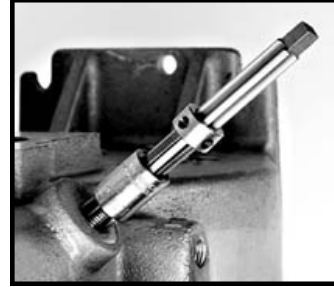

Adjustable Tap - Reamer Wrench

Capacity	Overall Length	Part No.
#0 to 1/4"	7"	ALF-TW63011
#0 to 3/8"	8"	ALF-TW63012
7-1/2", 1/8" NPT	11"	ALF-TW63013
7-3/4", 1/4" NPT	15"	ALF-TW63014
1/4" to 1/8", 3/4" NPT	19"	ALF-TW63015
1/2" to 1-3/8", 1/4" NPT	31"	ALF-TW63016
3/4" to 1-5/8", 3/8" to 1-1/4" NPT	40"	ALF-TW63017



Die Stock

Size	Overall Length	Part No.
13/16" O.D.	6-1/4"	ALF-DS63001
1"	9"	ALF-DS63002
1-1/2"	14"	ALF-DS63003
2"	23"	ALF-DS63004
2-1/2"	26"	ALF-DS63005
3"	22"	ALF-DS63006
4"	29"	ALF-DS63007



T-Handle Tap Wrenches

For Tap Sizes	Part No.
0 to 1/4"	CTD-50308
3/16" to 1/2"	CTD-50310
3/16" to 1/2" * Has removable handle and 3/8" female square drive for extensions.	CTD-50320



Features high speed cobalt steel teeth, and a high alloy steel body which is shatter resistant for superior durability.

4/6 variable pitch reduces vibration and heat generation for smooth cutting, and positive rake teeth offer better chip clearance. Cobalt Hole Saws cut holes in wood, plywood, plastic, fiberboard, or any machinable metal including pipe, and stainless steel.

Carbide Tipped:

Features Tungsten Carbide tipped teeth which provide highest wear resistance and longer life.

Replace (HOSA625 with HOSA732).

Hole Saw Diameter	Arbor Type *Sold Separately	Pipe Tap Size	R.P.M.		Part No.	
			Steel	Iron		
5/8"	Type A HOSA62590	3/4"	550	365	ALF-HOSA62502	
3/4"			460	300	ALF-HOSA62504	
7/8"			390	260	ALF-HOSA62506	
1"			350	235	ALF-HOSA62508	
1-1/8"			300	200	ALF-HOSA62510	
1-1/4"	Type B HOSA62591	1-1/4"	275	180	ALF-HOSA62512	
1-3/8"			250	165	ALF-HOSA62514	
1-1/2"			230	150	ALF-HOSA62516	
1-5/8"		1-1/2"	210	140	ALF-HOSA62518	
1-3/4"			195	130	ALF-HOSA62520	
1-7/8"			180	120	ALF-HOSA62522	
2"		2"	170	115	ALF-HOSA62524	
2-1/8"			160	105	ALF-HOSA62526	
2-1/4"			150	100	ALF-HOSA62528	
2-3/8"			140	95	ALF-HOSA62530	
2-1/2"			135	90	ALF-HOSA62532	
2-5/8"			2-1/2"	130	85	ALF-HOSA62534
2-3/4"			125	80	ALF-HOSA62536	
2-7/8"			120	80	ALF-HOSA62538	
3"			115	75	ALF-HOSA62540	

* Please call for sizes larger than 3"



Type A
HOSA62590



Type B
HOSA62591

Specialty Bi-Metal variable pitch hole saw kits are available in a variety of options.

All kits include Hole Saws, Arbors, Pilot Drills, and come in a strong molded plastic case.

Hole Saw Kit	Includes (1) Each	Part No.
13 Pc. Maintenance Kit	3/4", 7/8", 1-1/8", 1-1/2", 1-3/4", 2", 2-1/4", 2-1/2"	ALF-HOSA13
7 Pc. Mechanics Kit	7/8", 1", 1-1/8", 1-1/4", 1-1/2"	ALF-HOSA7
8 Pc. Plumbers Kit	3/4", 7/8", 1-1/8", 1-1/2", 1-3/4", 2-1/4"	ALF-HOSA8P
8 Pc. Electricians Kit	7/8", 1-1/8", 1-3/8", 1-3/4", 2", 2-1/2"	ALF-HOSA8E



Heavy duty HSS cutters make holes quickly and easily on sheet metal, pipe, tubing, and plastic up to 1/4" thick. Cuts much faster and last longer than equivalent size drills. Rota Cutters use less power and produces clean, burr-free holes. Automatically ejects the cut slug and are available in HSS or TiN coated.

Kits Include:

(1) Mini Rota Cutter in each size, Arbor with HSS split point drill and Arbor with spring loaded Ejector Pin, Set of Depth Washers, Hex Key, Center Punch, and spare Ejector pieces.



HSS



TiN Coated



Arbor A
ALF-MRCA

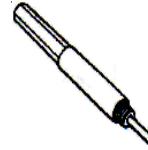

Arbor B
ALF-MRCB

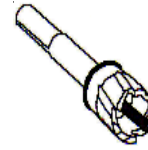

Ejector Pin
ALF-MRCP

Size	Decimal Equivalent	HSS Part No.	HSS TiN Part No.
5/16"	.3125	ALF-MRC101	ALF-MRC101TN
3/8"	.3750	ALF-MRC102	ALF-MRC102RN
7/16"	.4375	ALF-MRC103	ALF-MRC103TN
1/2"	.5000	ALF-MRC104	ALF-MRC104TN
9/16"	.5625	ALF-MRC105	ALF-MRC105TN
5/8"	.6250	ALF-MRC106	ALF-MRC106TN
3/4"	.7500	ALF-MRC107	ALF-MRC107TN
Kit		ALF-MRC7	ALF-MRC7TN



Annular Hole Cutters (Cobalt High Speed Steel)

Size	1" Depth	2" Depth	3" Depth
7/16"	ALF-RCCO74300	ALF-RCCO74350	
1/2"	ALF-RCCO74301	ALF-RCCO74351	
9/16"	ALF-RCCO74302	ALF-RCCO74352	
5/8"	ALF-RCCO74303	ALF-RCCO74353	
11/16"	ALF-RCCO74304	ALF-RCCO74354	
3/4"	ALF-RCCO74305	ALF-RCCO74355	
13/16"	ALF-RCCO74306	ALF-RCCO74356	ALF-RCCO74406
7/8"	ALF-RCCO74307	ALF-RCCO74357	ALF-RCCO74407
15/16"	ALF-RCCO74308	ALF-RCCO74358	ALF-RCCO74408
1"	ALF-RCCO74309	ALF-RCCO74359	ALF-RCCO74409
1-1/16"	ALF-RCCO74310	ALF-RCCO74360	ALF-RCCO74410
1-1/8"	ALF-RCCO74311	ALF-RCCO74361	ALF-RCCO74411
1-3/16"	ALF-RCCO74312	ALF-RCCO74362	ALF-RCCO74412
1-1/4"	ALF-RCCO74313	ALF-RCCO74363	ALF-RCCO74413
1-5/16"	ALF-RCCO74314	ALF-RCCO74364	ALF-RCCO74414
1-3/8"	ALF-RCCO74315	ALF-RCCO74365	ALF-RCCO74415
1-7/16"	ALF-RCCO74316	ALF-RCCO74366	ALF-RCCO74416
1-1/2"	ALF-RCCO74317	ALF-RCCO74367	ALF-RCCO74417
1-9/16"	ALF-RCCO74318	ALF-RCCO74368	ALF-RCCO74418
1-5/8"	ALF-RCCO74319	ALF-RCCO74369	ALF-RCCO74419
1-3/4"	ALF-RCCO74320	ALF-RCCO74370	ALF-RCCO74420
1-7/8"	ALF-RCCO74321	ALF-RCCO74371	ALF-RCCO74421
1-15/16"	ALF-RCCO74322	ALF-RCCO74372	ALF-RCCO74422
2"	ALF-RCCO74323	ALF-RCCO74373	ALF-RCCO74423

Dia.	4" Overall Length	6" Overall Length	8" Overall Length	10" Overall Length	12" Overall Length	14" Overall Length	16" Overall Length	18" Overall Length	24" Overall Length
5/32"	SDS62401	SDS62402							
3/16"	SDS62403	SDS62404	SDS62405	SDS62406	SDS62407				
7/32"		SDS62409	SDS62410	SDS62411	SDS62412		SDS62413		
1/4"	SDS62414	SDS62415	SDS62416	SDS62417	SDS62418	SDS62419	SDS62420		
5/16"		SDS62421			SDS62422				
3/8"		SDS62423		SDS62424	SDS62425			SDS62426	SDS62427
7/16"		SDS62428			SDS62429				
1/2"		SDS62430		SDS62431	SDS62432			SDS62433	SDS62434
9/16"		SDS62435			SDS62436			SDS62437	
5/8"		SDS62438	SDS62439		SDS62440			SDS62441	SDS62442
11/16"			SDS62443						
3/4"			SDS62444		SDS62445			SDS62446	
13/16"			SDS62447						
7/8"			SDS62448		SDS62449				
1"				SDS62450				SDS62452	

SDS-Max Hammer Drill Bits (For Concrete & Masonry)

Dia.	13" Overall Length	15" Overall Length	17" Overall Length	21" Overall Length	23" Overall Length	36" Overall Length
1/2"	SDSM62301			SDSM62303		
9/16"	SDSM62305			SDSM62307		
5/8"	SDSM62309			SDSM62311		SDSM62313
3/4"	SDSM62317			SDSM62319		SDSM62321
7/8"	SDSM62325			SDSM62327		
1"	SDSM62329			SDSM62331		SDSM62333
1-1/8"		SDSM62335			SDSM62337	
1-1/4"		SDSM62339			SDSM62341	SDSM62343
1-3/8"					SDSM62345	
1-1/2"					SDSM62347	



Core Bits (For Concrete & Masonry)

Core Bits are made to the same exacting standards as standard carbide tipped drill bits.

They utilize a centering bit to facilitate accurate drilling in combination hammer/drill mode. With One-Piece bits, once coring is begun the centering bit must be removed using ejector pin. Core bit bodies are 2-11/16" deep.

- SST-CTRBTF** Center Pilot Bit with Taper Fit
- SST-CDBEJKY** Ejector Key for Center Bit Removal



Core Bit	Length x Dia.	1-1/2"	2"	2-1/2"	3"	3-1/2"	4"	5"
One Piece w/ SDS-MAX	12" Length	CDBSX15012	CDBSX20012	CDBSX25012	CDBSX30012	CDBSX35012	CDBSX40012	CDBSX50012
	22" Length	CDBSX15022	CDBSX20022	CDBSX25022	CDBSX30022	CDBSX35022	CDBSX40022	CDBSX50022
Two Piece w/ Spline Shank	12" Length	CDBSP15012	CDBSP20012	CDBSP25012	CDBSP30012	CDBSP35012	CDBSP40012	CDBSP50012
	22" Length	CDBSP15022	CDBSP20022	CDBSP25022	CDBSP30022	CDBSP35022	CDBSP40022	CDBSP50022

Sets - Jobber Length Drill Sets (Type 190AG)

Total Pcs.	Includes	Part No.
13	1/16" to 1/4" by 64ths	CTD-44110
15	1/16" to 1/2" by 32nds	CTD-44120
21	1/16" to 3/8" by 64ths	CTD-44130
26	A to Z	CTD-88660
29	1/16" to 1/2" by 64ths	CTD-44150
60	#1 to #60	CTD-88640
115	1/16" to 1/2" by 64ths A to Z, and #1 to #60	CTD-93840

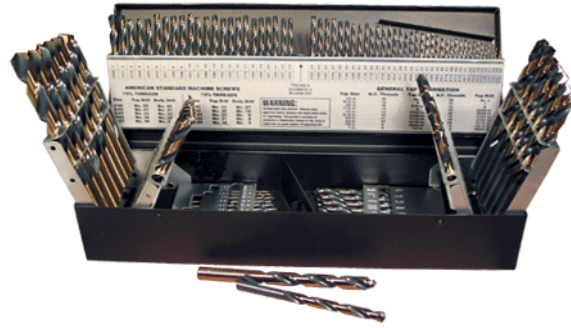

Sets - Mechanics Length Drill Sets (Type 175AG)

Total Pcs.	Includes	Part No.
13	1/16" to 1/4" by 64ths	CTD-66460
15	1/16" to 1/2" by 32nds	CTD-66470
21	1/16" to 3/8" by 64ths	CTD-57810
29	1/16" to 1/2" by 64ths	CTD-66480

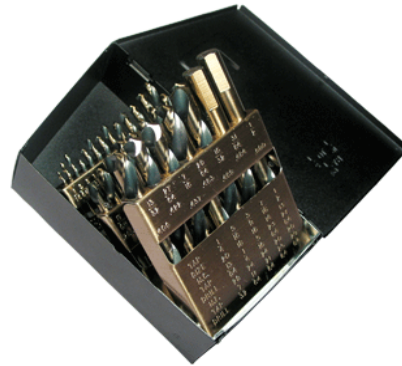

Sets - M42 Cobalt Jobbers Length Drill Sets (Type 150)

Total Pcs.	Includes	Part No.
13	1/16" to 1/4" by 64ths	CTD-68320
15	1/16" to 1/2" by 32nds	CTD-68340
21	1/16" to 3/8" by 64ths	CTD-68360
26	A to Z	CTD-68380
29	1/16" to 1/2" by 64ths	CTD-68400
60	#1 to #60	CTD-68420
115	1/16" to 1/2" by 64ths A to Z, and #1 to #60	CTD-69280

Sets - Screw Machine Drill Sets (Type 135AG)

Total Pcs.	Includes	Part No.
29	1/16" to 1/2" by 64ths	CTD-66490
60	#1 to #60	CTD-23560

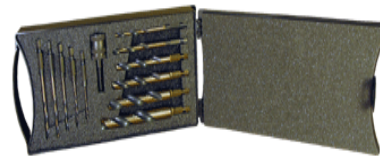

Sets - 1/2" Shank Silver & Deming Drill Sets (Type 130AG)

Total Pcs.	Includes	Part No.
4	5/16, 3/8, 7/16, & 1/2"	CTD-12250
8	1/16" to 1/2" by 16ths	CTD-92400



Sets - Bolt Remover Sets (Type 420 & 421AG)

Type	Includes	8 Pcs Set
Type 420 Spiral Style Type 190AL Left Hand Drills	EX1, EX2, EX3, EX4 3/32, 1/8, 3/16, and 1/4"	CTD-88550
Type 421AG Square Style Type 190AL Left Hand Drills	E1, E2, E3, E4 1/8, 3/16, 1/4 and 5/16	CTD-70850

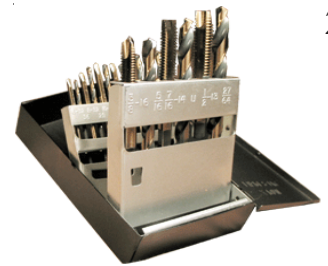

Sets - Tap & Drill Sets

Type	Includes	18 Pcs Set
20AG Tap Sizes (Coarse Thread) 190AG Drill Sizes	#36, 29, 25, 21, 7, F, 5/16, U, & 27/64 6-32, 8-32, 10-24, 10-32, 1/4-20, 5/16-18, 3/8-16, 7/16-14, & 1/2-13	CTD-57580
20AG Tap Sizes (Fine Thread) 190AG Drill Sizes	#33, 29, 25, 21, 3, 1, Q, 25/64, & 29/64 6-40, 8-36, 10-24, 10-32, 1/4-28, 5/16-24, 3/8-24, 7/16-20, & 1/2-20	CTD-58010
24AG Tap Sizes (Coarse Thread) 190AG Drill Sizes	#36, 29, 25, 21, 7, F, 5/16, U, & 27/64 6-32, 8-32, 10-24, 10-32, 1/4-20, 5/16-18, 3/8-16, 7/16-14, & 1/2-13	CTD-60930
24AG Tap Sizes (Fine Thread) 190AG Drill Sizes	#33, 29, 25, 21, 3, 1, Q, 25/64, & 29/64 6-40, 8-36, 10-24, 10-32, 1/4-28, 5/16-24, 3/8-24, 7/16-20, & 1/2-20	CTD-60940

Ultra Lube, High Performance Cutting Tool Lubricant

High viscosity, super concentrated no run formula.

Clings to verticle surfaces for continual lubrication. Extends tool life and yields a super smooth machined finish.

CTD-96050 4 oz. Bottle (12 per case or sold individually)

CTD-96070 16 oz. Bottle (12 per case or sold individually)

Lightweight Cutting Tool Oil formulated to improve metal cutting operations.

Cools and lubricates at the cutting point with run off or breakdown resistance.

Eliminates scoring and shaffer marks, and will prevent rust on newly machined parts.

SP-20-1557 18 oz. Aerosol (6 per case or sold individually)

(Alternate Anti-Seize Part No. AST-17051)



Also Available:

A complete line of Inch and Metric Drill sizes

Taper Length Drills

Extra Length Drills

A complete line of Silver & Deming Drills

Left hand thread Taps

Tap and Die Assortments

Left Hand Spiral Drills

Hole Expansion Tools

Auger Bits

Brad Point Drills and Power Bits

Rotary Saw Bits

Shatterproof Countersinks

A complete line of Masonry Drills, Rebar Cutters, Plate Cutters, Demolition Chisels and Bits

A complete line of Drill Sets and Storage Displays

