

EL-Cor Industries Inc.

www.elcorindustries.com
Phone (847) 465-7400 Fax (847) 465-9802

Brass & Pipe Fittings



Quick Reference Catalog

QRC-BPF2009

15 E. Palatine Road #105 - Prospect Heights IL. 60070

Pipe Fittings Index

Brass Pipe Fittings	Air Brake Fittings, D.O.T.	Pg. 11
	Air Brake Fittings, D.O.T. for Nylon Tubing	Pg. 12-13
	Air Brake Fittings, Push-Lock	Pg. 11-12
	Barb Fittings	Pg. 8
	Compression Fittings	Pg. 9
	Flared Pipe Fittings	Pg. 5-6
	Hydraulic Tube Fittings, J.I.C. 37	Pg. 13-14
	Inverted Flare Pipe Fittings	Pg. 6-7
	Pipe Fittings	Pg. 4-5
	Pipe Nipples	Pg. 5
	Poly-Grasp Fittings, for Poly Tubing	Pg. 10
	Stayput Barb Fittings	Pg. 7
Transmision "Sure-Grip" Fittings	Pg. 10	
Clamps	Automotive Hose Clamps	Pg. 24-25
	Fuel Injection Clamps	Pg. 26
	Muffler Clamps	Pg. 26
	Protective Hose Sleeving	Pg. 27-29
	Rubber Coated Tubing Clamps	Pg. 27
Couplers & Plugs	Air Tool Swivels	Pg. 17
	Double Shut-Off, Series FE (Flush Face)	Pg. 16
	Double Shut-Off, Series PC (Pioneer Series)	Pg. 16
	Single Shut-Off, Industrial Interchange	Pg. 15
	Single Shut-Off, Lincoln Interchange	Pg. 16
	Single Shut-Off, Parker/Truflate Interchange	Pg. 16
	Straight Through, Series ST	Pg. 17
	Universal Safety Couplers, Series U2	Pg. 15
Grease Fittings	Grease Fitting Caps	Pg. 18
	Grease Fittings	Pg. 18
	Hose Whips	Pg. 18
	Metric Grease Fittings	Pg. 18
	Universal Coupler for Grease Fittings	Pg. 18
Hose & Tubing	Air Brake Hose	Pg. 22
	Clear Vinyl Tubing	Pg. 22
	Coiled Nylon Tubing Assemblies	Pg. 23
	Copper Tubing	Pg. 22
	Fuel Line Hose	Pg. 21
	Heater Hose	Pg. 21
	Heavy Duty Air Hose	Pg. 23
	Nylon Air Brake Tubing	Pg. 22
Windshield & Vacuum Hose	Pg. 21	
Hose Fittings	Air Cocks	Pg. 20
	Cam and Groove Couplings	Pg. 19
	Heater Hose Fittings	Pg. 21
	Universal Crowfoot Couplings	Pg. 19
	Valves	Pg. 20
Malleable Pipe Fittings	Black Pipe Fittings	Pg. 1-2
	Galvanized Pipe Fittings	Pg. 1-2
	Pipe Nipples, Pre-Cut	Pg. 3
Air Coil Accessories	Aluminum Gladhands	Pg. 23
	Gladhand Grips	Pg. 23
	Gladhand Seals	Pg. 23

Size	Plug	
	Black Pipe	Galvanized
1/8"	PFB-109A	PFG-109A
1/4"	PFB-109C	PFG-109C
3/8"	PFB-109E	PFG-109E
1/2"	PFB-109F	PFG-109F
3/4"	PFB-109J	PFG-109J
1"	PFB-109N	PFG-109N
1-1/4"	PFB-109P	PFG-109P
1-1/2"	PFB-109Q	PFG-109Q
1-3/4"	PFB-109R	PFG-109R
2"	PFB-109S	PFG-109S

Size	Coupling	
	Black Pipe	Galvanized
1/8"	PFB-103A	PFG-103A
1/4"	PFB-103C	PFG-103C
3/8"	PFB-103E	PFG-103E
1/2"	PFB-103F	PFG-103F
3/4"	PFB-103J	PFG-103J
1"	PFB-103N	PFG-103N
1-1/4"	PFB-103P	PFG-103P
1-1/2"	PFB-103Q	PFG-103Q
1-3/4"	PFB-103R	PFG-103R
2"	PFB-103S	PFG-103S

Size	Merchant Coupling	
	Black Pipe	Galvanized
1/8"	PFB-103LA	PFG-103LA
1/4"	PFB-103LC	PFG-103LC
3/8"	PFB-103LE	PFG-103LE
1/2"	PFB-103LF	PFG-103LF
3/4"	PFB-103LJ	PFG-103LJ
1"	PFB-103LN	PFG-103LN
1-1/4"	PFB-103LP	PFG-103LP
1-1/2"	PFB-103LQ	PFG-103LQ
1-3/4"	PFB-103LR	PFG-103LR
2"	PFB-103LS	PFG-103LS

Size	Union	
	Black Pipe	Galvanized
1/8"	PFB-104A	PFG-104A
1/4"	PFB-104C	PFG-104C
3/8"	PFB-104E	PFG-104E
1/2"	PFB-104F	PFG-104F
3/4"	PFB-104J	PFG-104J
1"	PFB-104N	PFG-104N
1-1/4"	PFB-104P	PFG-104P
1-1/2"	PFB-104Q	PFG-104Q
1-3/4"	PFB-104R	PFG-104R
2"	PFB-104S	PFG-104S

Size	Pipe Cap	
	Black Pipe	Galvanized
1/8"	PFB-108A	PFG-108A
1/4"	PFB-108C	PFG-108C
3/8"	PFB-108E	PFG-108E
1/2"	PFB-108F	PFG-108F
3/4"	PFB-108J	PFG-108J
1"	PFB-108N	PFG-108N
1-1/4"	PFB-108P	PFG-108P
1-1/2"	PFB-108Q	PFG-108Q
1-3/4"	PFB-108R	PFG-108R
2"	PFB-108S	PFG-108S

Size	Pipe Tee	
	Black Pipe	Galvanized
1/8"	PFB-101A	PFG-101A
1/4"	PFB-101C	PFG-101C
3/8"	PFB-101E	PFG-101E
1/2"	PFB-101F	PFG-101F
3/4"	PFB-101J	PFG-101J
1"	PFB-101N	PFG-101N
1-1/4"	PFB-101P	PFG-101P
1-1/2"	PFB-101Q	PFG-101Q
1-3/4"	PFB-101R	PFG-101R
2"	PFB-101S	PFG-101S

Size	90° Elbow	
	Black Pipe	Galvanized
1/8"	PFB-100A	PFG-100A
1/4"	PFB-100C	PFG-100C
3/8"	PFB-100E	PFG-100E
1/2"	PFB-100F	PFG-100F
3/4"	PFB-100J	PFG-100J
1"	PFB-100N	PFG-100N
1-1/4"	PFB-100P	PFG-100P
1-1/2"	PFB-100Q	PFG-100Q
1-3/4"	PFB-100R	PFG-100R
2"	PFB-100S	PFG-100S

Size	90° Street Elbow	
	Black Pipe	Galvanized
1/8"	PFB-116A	PFG-116A
1/4"	PFB-116C	PFG-116C
3/8"	PFB-116E	PFG-116E
1/2"	PFB-116F	PFG-116F
3/4"	PFB-116J	PFG-116J
1"	PFB-116N	PFG-116N
1-1/4"	PFB-116P	PFG-116P
1-1/2"	PFB-116Q	PFG-116Q
1-3/4"	PFB-116R	PFG-116R
2"	PFB-116S	PFG-116S

Size	45° Elbow	
	Black Pipe	Galvanized
1/8"	PFB-129A	PFG-129A
1/4"	PFB-129C	PFG-129C
3/8"	PFB-129E	PFG-129E
1/2"	PFB-129F	PFG-129F
3/4"	PFB-129J	PFG-129J
1"	PFB-129N	PFG-129N
1-1/4"	PFB-129P	PFG-129P
1-1/2"	PFB-129Q	PFG-129Q
1-3/4"	PFB-129R	PFG-129R
2"	PFB-129S	PFG-129S



Plug



Coupling



Merchant Coupling

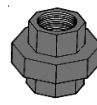

Union



Pipe Cap

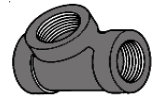

Pipe Tee

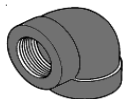

90° Elbow



90° Street Elbow

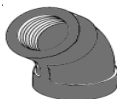

45° Elbow

Size	45° Street Elbow	
	Black Pipe	Galvanized
1/8"	PFB-124A	PFG-124A
1/4"	PFB-124C	PFG-124C
3/8"	PFB-124E	PFG-124E
1/2"	PFB-124F	PFG-124F
3/4"	PFB-124J	PFG-124J
1"	PFB-124N	PFG-124N
1-1/4"	PFB-124P	PFG-124P
1-1/2"	PFB-124Q	PFG-124Q
1-3/4"	PFB-124R	PFG-124R
2"	PFB-124S	PFG-124S

Size	Cross	
	Black Pipe	Galvanized
1/8"	PFB-102A	PFG-102A
1/4"	PFB-102C	PFG-102C
3/8"	PFB-102E	PFG-102E
1/2"	PFB-102F	PFG-102F
3/4"	PFB-102J	PFG-102J
1"	PFB-102N	PFG-102N
1-1/4"	PFB-102P	PFG-102P
1-1/2"	PFB-102Q	PFG-102Q
1-3/4"	PFB-102R	PFG-102R
2"	PFB-102S	PFG-102S

Size	Floor Flange	
	Black Pipe	Galvanized
1/8"		
1/4"	PFB-521-601	PFG-521-601
3/8"	PFB-521-602	PFG-521-602
1/2"	PFB-521-603	PFG-521-603
3/4"	PFB-521-604	PFG-521-604
1"	PFB-521-605	PFG-521-605
1-1/4"	PFB-521-606	PFG-521-606
1-1/2"	PFB-521-607	PFG-521-607
1-3/4"		
2"	PFB-521-608	PFG-521-608

Size	Hex Bushing	
	Black Pipe	Galvanized
1/4" x 1/8"	PFB-110C	PFG-110C
3/8" x 1/8"	PFB-110E	PFG-110E
3/8" x 1/4"	PFB-110EE	PFG-110EE
1/2" x 1/8"	PFB-110FA	PFG-110FA
1/2" x 1/4"	PFB-110FC	PFG-110FC
1/2" x 3/8"	PFB-110F	PFG-110F
3/4" x 1/8"	PFB-110JA	PFG-110JA
3/4" x 1/4"	PFB-110JC	PFG-110JC
3/4" x 3/8"	PFB-110JE	PFG-110JE
3/4" x 1/2"	PFB-110J	PFG-110J
1" x 1/4"	PFB-110NC	PFG-110NC
1" x 3/8"	PFB-110NE	PFG-110NE
1" x 1/2"	PFB-110NF	PFG-110NF
1" x 3/4"	PFB-110NJ	PFG-110NJ
1-1/4" x 1/4"	PFB-110PC	PFG-110PC
1-1/4" x 3/8"	PFB-110PE	PFG-110PE
1-1/4" x 1/2"	PFB-110PF	PFG-110PF
1-1/4" x 3/4"	PFB-110PJ	PFG-110PJ
1-1/4" x 1"	PFB-110PN	PFG-110PN
1-1/2" x 1/4"	PFB-110QC	PFG-110QC
1-1/2" x 3/8"	PFB-110QE	PFG-110QE
1-1/2" x 1/2"	PFB-110QF	PFG-110QF
1-1/2" x 3/4"	PFB-110QJ	PFG-110QJ
1-1/2" x 1"	PFB-110QN	PFG-110QN
1-1/2" x 1-1/4"	PFB-110QP	PFG-110QP
2" x 3/8"	PFB-110RE	PFG-110RE
2" x 1/2"	PFB-110RF	PFG-110RF
2" x 3/4"	PFB-110RJ	PFG-110RJ
2" x 1"	PFB-110RN	PFG-110RN
2" x 1-1/4"	PFB-110RP	PFG-110RP
2" x 1-1/2"	PFB-110RQ	PFG-110RQ
2" x 2"	PFB-110SR	PFG-110SR

Size	Reducing Coupling	
	Black Pipe	Galvanized
1/4" x 1/8"	PFB-119C	PFG-119C
3/8" x 1/8"	PFB-119E	PFG-119E
3/8" x 1/4"	PFB-119EE	PFG-119EE
1/2" x 1/8"	PFB-119FA	PFG-119FA
1/2" x 1/4"	PFB-119FC	PFG-119FC
1/2" x 3/8"	PFB-119F	PFG-119F
3/4" x 1/8"	PFB-119JA	PFG-119JA
3/4" x 1/4"	PFB-119JC	PFG-119JC
3/4" x 3/8"	PFB-119JE	PFG-119JE
3/4" x 1/2"	PFB-119FJ	PFG-119FJ
1" x 1/4"	PFB-119NC	PFG-119NC
1" x 3/8"	PFB-119NE	PFG-119NE
1" x 1/2"	PFB-119NF	PFG-119NF
1" x 3/4"	PFB-119NJ	PFG-119NJ
1-1/4" x 1/4"		
1-1/4" x 3/8"	PFB-119PE	PFG-119PE
1-1/4" x 1/2"	PFB-119PF	PFG-119PF
1-1/4" x 3/4"	PFB-119PJ	PFG-119PJ
1-1/4" x 1"	PFB-119PN	PFG-119PN
1-1/2" x 1/4"		
1-1/2" x 3/8"	PFB-119QE	PFG-119QE
1-1/2" x 1/2"	PFB-119QF	PFG-119QF
1-1/2" x 3/4"	PFB-119QJ	PFG-119QJ
1-1/2" x 1"	PFB-119QN	PFG-119QN
1-1/2" x 1-1/4"	PFB-119QP	PFG-119QP
2" x 3/8"		
2" x 1/2"	PFB-119RF	PFG-119RF
2" x 3/4"	PFB-119RJ	PFG-119RJ
2" x 1"	PFB-119RN	PFG-119RN
2" x 1-1/4"	PFB-119RP	PFG-119RP
2" x 1-1/2"	PFB-119RQ	PFG-119RQ
2" x 2"	PFB-119SR	PFG-119SR



45° Street Elbow



Cross

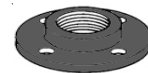

Floor Flange



Hex Bushing

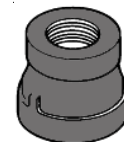

Reducing Coupling

Length	1/8" Diameter	1/4" Diameter	3/8" Diameter	1/2" Diameter	3/4" Diameter	1" Diameter	1-1/4" Diameter	1-1/2" Diameter	2" Diameter
Close	112A	112C	112E	112F	112J	112N	112P	112Q	112R
1-1/2"	117A1-1/2	117C1-1/2	117E1-1/2	117F1-1/2	117J1-1/2	117N1-1/2	117P1-1/2	117Q1-1/2	117R1-1/2
2"	117A2	117C2	117E2	117F2	117J2	117N2	117P2	117Q2	117R2
2-1/2"	117A2-1/2	117C2-1/2	117E2-1/2	117F2-1/2	117J2-1/2	117N2-1/2	117P2-1/2	117Q2-1/2	117R2-1/2
3"	117A3	117C3	117E3	117F3	117J3	117N3	117P3	117Q3	117R3
3-1/2"	117A3-1/2	117C3-1/2	117E3-1/2	117F3-1/2	117J3-1/2	117N3-1/2	117P3-1/2	117Q3-1/2	117R3-1/2
4"	117A4	117C4	117E4	117F4	117J4	117N4	117P4	117Q4	117R4
4-1/2"	117A4-1/2	117C4-1/2	117E4-1/2	117F4-1/2	117J4-1/2	117N4-1/2	117P4-1/2	117Q4-1/2	117R4-1/2
5"	117A5	117C5	117E5	117F5	117J5	117N5	117P5	117Q5	117R5
5-1/2"	117A5-1/2	117C5-1/2	117E5-1/2	117F5-1/2	117J5-1/2	117N5-1/2	117P5-1/2	117Q5-1/2	117R5-1/2
6"	117A6	117C6	117E6	117F6	117J6	117N6	117P6	117Q6	117R6

We offer an extensive line of black and galvanized steel nipples.

Available pre-cut to lengths listed above, or available in longer lengths all the way up to 60" long upon request.

Black Pipe: Use pre-fix, PFB-

Galvanized Pipe: Use pre-fix, PFG-

Red Brass: Use pre-fix, PFRB-



Pipe Fittings (Brass)

Size	Plug Male Pipe
1/8"	BF-109A
1/4"	BF-109C
3/8"	BF-109E
1/2"	BF-109F
3/4"	BF-109J
1"	BF-109N



Size	Hex Plug Male Pipe
1/8"	BF-109XA
1/4"	BF-109XC
3/8"	BF-109XE
1/2"	BF-109XF
3/4"	BF-109XJ
1"	BF-109XN



Size	Countersunk Plug Male Pipe
1/8"	BF-109UA
1/4"	BF-109UC
3/8"	BF-109UE
1/2"	BF-109UF
3/4"	BF-109UJ
1"	BF-109UN



Size	Coupling Female Pipe
1/8"	BF-103A
1/4"	BF-103C
3/8"	BF-103E
1/2"	BF-103F
3/4"	BF-103J
1"	BF-103N



Size	Union Female Pipe
1/8"	BF-104A
1/4"	BF-104C
3/8"	BF-104E
1/2"	BF-104F
3/4"	BF-104J
1"	BF-104N



Size	Pipe Cap Female Pipe
1/8"	BF-108A
1/4"	BF-108C
3/8"	BF-108E
1/2"	BF-108F
3/4"	BF-108J
1"	BF-108N



Size	Pipe Tee Female Pipe
1/8"	BF-101A
1/4"	BF-101C
3/8"	BF-101E
1/2"	BF-101F
3/4"	BF-101J
1"	BF-101N



Size	Cross Female Pipe
1/8"	BF-102A
1/4"	BF-102C
3/8"	BF-102E
1/2"	BF-102F
3/4"	BF-102J
1"	BF-102N



* Extruded PN: BF-101S_

Size	90° Elbow Female Pipe
1/8"	BF-100A
1/4"	BF-100C
3/8"	BF-100E
1/2"	BF-100F
3/4"	BF-100J
1"	BF-100N



Size	90° Street Elbow
1/8"	BF-116SA-97
1/4"	BF-116SC-97
3/8"	BF-116SE-30
1/2"	BF-116SF
3/4"	BF-116SJ
1"	



Size	45° St. Elbow Female x Male
1/8"	BF-124A
1/4"	BF-124C
3/8"	BF-124E
1/2"	BF-124F
3/4"	BF-124J
1"	BF-124N



Size	45° St. Elbow Female Pipe
1/8"	BF-129A
1/4"	BF-129C
3/8"	BF-129E
1/2"	BF-129F
3/4"	BF-129J
1"	BF-129N



* Extruded PN: BF-100S_

* Extruded PN: BF-124S_

Size	Hex Bushing Male x Female Pipe
1/4" x 1/8"	BF-110C
3/8" x 1/8"	BF-110E
3/8" x 1/4"	BF-110EE
1/2" x 1/8"	BF-110FA
1/2" x 1/4"	BF-110FC
1/2" x 3/8"	BF-110F
3/4" x 1/8"	BF-110JA
3/4" x 1/4"	BF-110JC
3/4" x 3/8"	BF-110JE
3/4" x 1/2"	BF-110J
1" x 1/4"	BF-110NC
1" x 3/8"	BF-110NE
1" x 1/2"	BF-110NF
1" x 3/4"	BF-110NJ



Size	Reducing Coupling Female x Female Pipe
1/4" x 1/8"	BF-119C
3/8" x 1/8"	BF-119E
3/8" x 1/4"	BF-1109E
1/2" x 1/8"	BF-1109A
1/2" x 1/4"	BF-119FC
1/2" x 3/8"	BF-119F
3/4" x 1/8"	
3/4" x 1/4"	BF-119JC
3/4" x 3/8"	BF-119JE
3/4" x 1/2"	BF-119J
1" x 1/4"	
1" x 3/8"	
1" x 1/2"	
1" x 3/4"	BF-119NJ



Size	Reducing Adapter Female x Male Pipe
1/4" x 1/8"	BF-120RCA
3/8" x 1/8"	BF-120REA
3/8" x 1/4"	BF-120REC
1/2" x 1/8"	
1/2" x 1/4"	BF-120RFC
1/2" x 3/8"	BF-120RFE
3/4" x 1/8"	
3/4" x 1/4"	
3/4" x 3/8"	BF-120RJE
3/4" x 1/2"	BF-120RJF
1" x 1/4"	
1" x 3/8"	
1" x 1/2"	
1" x 3/4"	



Pipe Nipples (Brass)

Size	1/8" Nipple	1/4" Nipple	3/8" Nipple	1/2" Nipple	3/4" Nipple	1" Nipple
Close	BF-112A	BF-112C	BF-112E	BF-112F	BF-112J	BF-112N
Hex	BF-112XA	BF-112XC	BF-112XE	BF-112XF	BF-112XJ	BF-112XN
1-1/2"	BF-117A1-1/2	BF-117C1-1/2	BF-117E1-1/2	BF-117F1-1/2	BF-117J1-1/2	BF-117N1-1/2
2"	BF-117A2	BF-117C2	BF-117E2	BF-117F2	BF-117J2	BF-117N2
2-1/2"	BF-117A2-1/2	BF-117C2-1/2	BF-117E2-1/2	BF-117F2-1/2	BF-117J2-1/2	BF-117N2-1/2
3"	BF-117A3	BF-117C3	BF-117E3	BF-117F3	BF-117J3	BF-117N3
3-1/2"	BF-117A3-1/2	BF-117C3-1/2	BF-117E3-1/2	BF-117F3-1/2	BF-117J3-1/2	BF-117N3-1/2
4"	BF-117A4	BF-117C4	BF-117E4	BF-117F4	BF-117J4	BF-117N4
4-1/2"	BF-117A4-1/2	BF-117C4-1/2	BF-117E4-1/2	BF-117F4-1/2	BF-117J4-1/2	BF-117N4-1/2
5"	BF-117A5	BF-117C5	BF-117E5	BF-117F5	BF-117J5	BF-117N5
5-1/2"	BF-117A5-1/2	BF-117C5-1/2	BF-117E5-1/2	BF-117F5-1/2	BF-117J5-1/2	BF-117N5-1/2
6"	BF-117A6	BF-117C6	BF-117E6	BF-117F6	BF-117J6	BF-117N6



Close Nipple (BF-112_)



Hex Nipple (BF-112_X)



Pipe Nipple (BF-117_)

Pipe Nipples (Brass)

Size	Reducing Hex Nipple Male x Male Pipe
1/4" x 1/8"	BF-112RCA
3/8" x 1/8"	BF-112REA
3/8" x 1/4"	BF-112REC
1/2" x 1/4"	BF-112RFC
1/2" x 3/8"	BF-112RFE
3/4" x 1/2"	BF-112RJF



Flared Pipe Fittings (Brass)

Size	Nut Tube O.D.
1/8"	BF-41A
3/16"	BF-41B
1/4"	BF-41C
5/16"	BF-41D
3/8"	BF-41E
1/2"	BF-41F
5/8"	BF-41H
3/4"	BF-41J



Size	Nut, Long Tube O.D.
1/8"	BF-141A
3/16"	BF-141B
1/4"	BF-141C
5/16"	BF-141D
3/8"	BF-141E
1/2"	BF-141F
5/8"	BF-141H
3/4"	BF-141J



Size	Union Tube O.D.
1/8"	BF-42A
3/16"	BF-42B
1/4"	BF-42C
5/16"	BF-42D
3/8"	BF-42E
1/2"	BF-42F
5/8"	BF-42H
3/4"	BF-42J



Size	Union Elbow Tube O.D.
1/8"	BF-55A
3/16"	BF-55B
1/4"	BF-55C
5/16"	BF-55D
3/8"	BF-55E
1/2"	BF-55F
5/8"	BF-55H
3/4"	BF-55J



Size	Tee Tube O.D.
1/8"	BF-44A
3/16"	BF-44B
1/4"	BF-44C
5/16"	BF-44D
3/8"	BF-44E
1/2"	BF-44F
5/8"	BF-44H
3/4"	BF-44J



Flared Pipe Fittings (Brass)

Size	Male Connector Tube O.D. x Male Pipe	Female Connector Tube O.D. x Female Pipe	Male Elbow Tube O.D. x Male Pipe	45° Male Elbow Tube O.D. x Male Pipe	Female Elbow Tube O.D. x Female Pipe
1/8" x 1/8"	BF-48A	BF-46A	BF-49A		
3/16" x 1/8"	BF-48B	BF-46B	BF-49B	BF-56B	BF-50B
3/16" x 1/4"					
1/4" x 1/8"	BF-48C	BF-46C	BF-49C	BF-56C	BF-50C
1/4" x 1/4"	BF-48CC	BF-46CC	BF-49CC	BF-56CC	BF-50CC
1/4" x 3/8"	BF-48CE	BF-46CE	BF-49CE	BF-56CE	BF-50CE
1/4" x 1/2"	BF-48CF	BF-46CF	BF-49CF		BF-50CF
5/16" x 1/8"	BF-48D	BF-46D	BF-49D	BF-56D	BF-50D
5/16" x 1/4"	BF-48DD	BF-46DD	BF-49DD	BF-56DD	BF-50DD
5/16" x 3/8"	BF-48DE		BF-49DE		
3/8" x 1/8"	BF-48E	BF-46E	BF-49E		BF-50E
3/8" x 1/4"	BF-48EE	BF-46EE	BF-49EE	BF-56EE	BF-50EE
3/8" x 3/8"	BF-48EEE	BF-46EEE	BF-49EEE	BF-56EEE	BF-50EEE
3/8" x 1/2"	BF-48EF	BF-46EF	BF-49EF	BF-56EF	BF-50EF
3/8" x 3/4"	BF-48EJ	BF-46EJ	BF-49EJ		BF-50EJ
1/2" x 1/4"	BF-48FC	BF-46FC	BF-49FC		BF-50FC
1/2" x 3/8"	BF-48F	BF-46F	BF-49F	BF-56F	BF-50F
1/2" x 1/2"	BF-48FF	BF-46FF	BF-49FF	BF-56FF	BF-50FF
1/2" x 3/4"	BF-48FJ	BF-46FJ	BF-49FJ		BF-50FJ
5/8" x 3/8"	BF-48HE	BF-46HE	BF-49HE		BF-50HE
5/8" x 1/2"	BF-48H	BF-46H	BF-49H	BF-56H	BF-50H
5/8" x 3/4"	BF-48HJ	BF-46HJ	BF-49HJ		BF-50HJ
3/4" x 1/2"	BF-48J		BF-49J	BF-56J	BF-50J
3/4" x 3/4"	BF-48JJ	BF-46JJ	BF-49JJ	BF-56JJ	BF-50JJ



Male Connector



Female Connector



Male Elbow



45° Male Elbow



Female Elbow

Inverted Flare Pipe Fittings (Brass)

Size	Nut Tube O.D.
1/8"	BF-105A
3/16"	BF-105B
1/4"	BF-105C
5/16"	BF-105D
3/8"	BF-105E
1/2"	BF-105F
5/8"	
3/4"	



Size	Nut, Long Tube O.D.
1/8"	BF-105SA
3/16"	BF-105SB
1/4"	BF-105SC
5/16"	BF-105SD
3/8"	BF-105SE
1/2"	BF-105SF
5/8"	BF-105SH
3/4"	BF-105SJ



Size	Steel Plug Tube O.D.
1/8"	
3/16"	BF-409BS
1/4"	BF-409CS
5/16"	BF-409DS
3/8"	BF-409ES
1/2"	
5/8"	
3/4"	



Size	Union Tube O.D.
1/8"	BF-353A
3/16"	BF-353B
1/4"	BF-353C
5/16"	BF-353D
3/8"	BF-353E
1/2"	BF-353F
5/8"	
3/4"	



Inverted Flare Pipe Fittings (Brass)

Size	Male Connector Tube O.D. x Male Pipe	Male Elbow Tube O.D. x Male Pipe	45° Male Elbow Tube O.D. x Male Pipe	Conversion Adapter Female Tube x Male Tube	Female Connector Tube O.D. x Female Pipe
1/8" x 1/8"	BF-200A	BF-402A			
3/16" x 1/8"	BF-200B	BF-400B	BF-352B		BF-250B
3/16" x 1/4"				BF-240BC	
3/16" x 5/16"				BF-240BD	
1/4" x 1/8"	BF-200C	BF-400C	BF-352C		BF-250C
1/4" x 3/16"				BF-240CB	
1/4" x 1/4"	BF-200CC	BF-402CC			
1/4" x 5/16"				BF-240CD	
5/16" x 1/8"	BF-200D	BF-400D	BF-352D		BF-250D
5/16" x 1/4"	BF-200DD	BF-402DD	BF-352DD	BF-240DC	
5/16" x 3/8"	BF-202DE			BF-240DE	
3/8" x 1/8"	BF-200E	BF-402E			
3/8" x 1/4"	BF-200EE	BF-402EE	BF-352EE		BF-250EE
3/8" x 5/16"				BF-240ED	
3/8" x 3/8"	BF-200EEE	BF-402EEE			
1/2" x 1/4"	BF-202FC	BF-402FC			
1/2" x 3/8"	BF-202F	BF-402F	BF-352F		BF-250F
1/2" x 1/2"	BF-202FF	BF-402FF			
5/8" x 1/2"	BF-202H	BF-402H	BF-352H		
3/4" x 3/4"	BF-202JJ				



Male Connector (BF-200_)



Male Elbow (BF-400_)



45° Male Elbow (BF-352_)



Conversion Adapter (BF-240_)



Female Connector (BF-250_)

Stayput Barb Fittings (Brass)

Size	Male Hose Barb Push On Hose I.D. x Male Pipe	45° Swivel Nut Push On Hose I.D. x Flare Nut	Male Elbow Push On Hose I.D. x Male Pipe	Inverted Nut Push On Hose I.D. x Flare Nut	Splicer Push On Hose I.D.
1/4" x 1/8"	BF-920C		BF-929LC		
1/4" x 1/4"	BF-920CC	BF-940CC	BF-929LCC	BF-905CC	BF-922C
1/4" x 3/8"	BF-920CE	BF-940CE			
5/16" x 1/8"	BF-920D	BF-940D	BF-929LD		
5/16" x 1/4"	BF-920DD		BF-929LDD	BF-905DC	
5/16" x 5/16"		BF-940DDD		BF-905DDD	BF-922D
5/16" x 3/8"		BF-940DE		BF-905DE	
3/8" x 1/8"	BF-920E		BF-929LE		
3/8" x 1/4"	BF-920EE		BF-929LEE		
3/8" x 3/8"	BF-920EEE	BF-940EEE	BF-929LEEE	BF-905EEE	BF-922E
3/8" x 1/2"	BF-920EF	BF-940EF			
1/2" x 1/4"	BF-920FC				
1/2" x 3/8"	BF-920F	BF-940F	BF-929LF		
1/2" x 1/2"	BF-920FF	BF-940FF	BF-929LFF	BF-905FF	BF-922F
1/2" x 3/4"	BF-920FJ				
5/8" x 3/8"	BF-920HE				
5/8" x 1/2"	BF-920H	BF-940HF			
5/8" x 5/8"		BF-940HH			BF-922H
5/8" x 3/4"	BF-920HJ				
3/4" x 1/2"	BF-920J				
3/4" x 3/4"	BF-920JJ	BF-940JJ	BF-929LJJ		



Male Hose Barb (BF-920_)



45° Swivel Flare Nut (BF-940_)



Male Elbow (BF-929L_)



Inverted Nut (BF-905_)



Splicer (BF-922_)

Barb Fittings (Brass)

Size	Male Hose Barb Hose O.D. x Male Pipe	Female Hose Barb Hose O.D. x Female Pipe	Male Elbow Hose O.D. x Male Pipe	Female Elbow Hose O.D. x Female Pipe	Splicer Hose I.D.
1/8" x 1/8"	BF-220A	BF-221A			
1/8" x 1/4"	BF-220AC				
3/16" x 1/8"	BF-220B	BF-221B	BF-220LB		
3/16" x 1/4"	BF-220BB	BF-221BB			
1/4" x 1/8"	BF-220C	BF-221C	BF-220LC	BF-231C	
1/4" x 1/4"	BF-220CC	BF-221CC	BF-220LCC	BF-231CC	BF-222C
1/4" x 3/8"	BF-220CE	BF-221CE	BF-220LCE		
1/4" x 1/2"	BF-220CF				
5/16" x 1/8"	BF-220D	BF-221D	BF-220LD	BF-231D	
5/16" x 1/4"	BF-220DD	BF-221DD	BF-220LDD	BF-231DD	
5/16" x 5/16"					BF-222D
5/16" x 3/8"	BF-220DE	BF-221DE	BF-220LDE		
3/8" x 1/8"	BF-220E	BF-221E	BF-220LE	BF-231E	
3/8" x 1/4"	BF-220EE	BF-221EE	BF-220LEE	BF-231EE	
3/8" x 3/8"	BF-220EEE	BF-221EEE	BF-220LEEE	BF-231EEE	BF-222E
3/8" x 1/2"	BF-220EF	BF-221EF	BF-220LEF		
3/8" x 3/4"	BF-220EJ				
1/2" x 1/4"	BF-220FC	BF-221FC	BF-220LFC		
1/2" x 3/8"	BF-220F	BF-221F	BF-220LF		
1/2" x 1/2"	BF-220FF	BF-221FF	BF-220LFF		BF-222F
1/2" x 3/4"	BF-220FJ				
5/8" x 1/4"	BF-220HC				
5/8" x 3/8"	BF-220HE		BF-220LHE		
5/8" x 1/2"	BF-220H		BF-220LH		
5/8" x 5/8"					BF-222H
5/8" x 3/4"	BF-220HJ				
3/4" x 3/8"	BF-220JE				
3/4" x 1/2"	BF-220J		BF-220LJ		
3/4" x 3/4"	BF-220JJ	BF-221JJ	BF-220LJJ		BF-222J



**Male
Hose Barb
(BF-220_)**



**Female
Hose Barb
(BF-221_)**



**Male Elbow
(BF-220L_)**



**Female Elbow
(BF-231)**



**Splicer
(BF-222_)**

Compression Fittings (Brass)

Size	Sleeve Tube O.D.	Size	Nut Tube O.D.	Size	Brass Insert Tube O.D.	Size	Tee Tube O.D.	Size	Union Tube O.D.
1/8"	BF-60A	1/8"	BF-61A	1/8"	BF-461A-80	1/8"	BF-64A	1/8"	BF-62A
3/16"	BF-60B	3/16"	BF-61B	3/16"	BF-461B-80	3/16"	BF-64B	3/16"	BF-62B
1/4"	BF-60C	1/4"	BF-61C	1/4"	BF-461C	1/4"	BF-64C	1/4"	BF-62C
5/16"	BF-60D	5/16"	BF-61D	5/16"	BF-461D	5/16"	BF-64D	5/16"	BF-62D
3/8"	BF-60E	3/8"	BF-61E	3/8"	BF-461E	3/8"	BF-64E	3/8"	BF-62E
1/2"	BF-60F	1/2"	BF-61F	1/2"	BF-461F	1/2"	BF-64F	1/2"	BF-62F
5/8"	BF-60H	5/8"	BF-61H	5/8"	BF-461H	5/8"	BF-64H	5/8"	BF-62H
3/4"	BF-60J	3/4"	BF-61J	3/4"	BF-461J	3/4"	BF-64J	3/4"	BF-62J



Sleeve (BF-60_)



Nut (BF-61_)



Brass Insert (BF-461_)



Tee (BF-64_)



Union (BF-62_)

Size	Male Connector Tube O.D. x Male Pipe	Female Connector Tube O.D. x Female Pipe	Male Elbow Tube O.D. x Male Pipe	45° Male Elbow Tube O.D. x Male Pipe	Female Elbow Tube O.D. x Female Pipe
1/8" x 1/8"	BF-68A	BF-66A	BF-69A		BF-70A
3/16" x 1/8"	BF-68B	BF-66B	BF-69B	BF-78B	BF-70B
3/16" x 1/4"	BF-68BB	BF-66BB	BF-69BB		
1/4" x 1/8"	BF-68C	BF-66C	BF-69C	BF-78C	BF-70C
1/4" x 1/4"	BF-68CC	BF-66CC	BF-69CC	BF-78CC	BF-70CC
1/4" x 3/8"	BF-68CE	BF-66CE	BF-69CE		BF-70CE
1/4" x 1/2"	BF-68CF	BF-66CF	BF-69CF		BF-70CF
5/16" x 1/8"	BF-68D	BF-66D	BF-69D	BF-78D	BF-70D
5/16" x 1/4"	BF-68DD	BF-66DD	BF-69DD	BF-78DD	BF-70DD
5/16" x 3/8"	BF-68DE	BF-66DE	BF-69DE		
5/16" x 1/2"	BF-68DF		BF-69DF		
3/8" x 1/8"	BF-68E	BF-66E	BF-69E	BF-78E	BF-70E
3/8" x 1/4"	BF-68EE	BF-66EE	BF-69EE	BF-78EE	BF-70EE
3/8" x 3/8"	BF-68EEE	BF-66EEE	BF-69EEE	BF-78EEE	BF-70EEE
3/8" x 1/2"	BF-68EF	BF-66EF	BF-69EF		BF-70EF
3/8" x 3/4"	BF-68EJ	BF-66EJ	BF-69EJ		BF-70EJ
1/2" x 1/4"	BF-68FC	BF-66FC	BF-69FC		BF-70FC
1/2" x 3/8"	BF-68F	BF-66F	BF-69F	BF-78F	BF-70F
1/2" x 1/2"	BF-68FF	BF-66FF	BF-69FF	BF-78FF	BF-70FF
1/2" x 3/4"	BF-68FJ	BF-66FJ	BF-69FJ		BF-70FJ
5/8" x 3/8"	BF-68HE	BF-66HE	BF-69HE		BF-70HE
5/8" x 1/2"	BF-68H	BF-66H	BF-69H	BF-78H	BF-70H
5/8" x 3/4"	BF-68HJ	BF-66HJ	BF-69HJ		BF-70HJ
3/4" x 1/2"	BF-68J	BF-66J	BF-69J		BF-70J
3/4" x 3/4"	BF-68JJ	BF-66JJ	BF-69JJ		BF-70JJ



Male Connector (BF-68_)



Female Connector (BF-66_)



Male Elbow (BF-69_)



45° Male Elbow (BF-78_)



Female Elbow (BF-70_)

Poly-Grasp Fittings for Poly Tubing (Brass)

Size	Plastic Sleeve Poly Tube O.D.	Size	Brass Nut Poly Tube O.D.	Size	Nut & Sleeve Poly Tube O.D.	Size	Union Poly Tube O.D.	Size	Tee Poly Tube O.D.
1/8"		1/8"		1/8"	BF-PGCS61A	1/8"	BF-CS62A	1/8"	BF-CS64A
3/16"		3/16"		3/16"	BF-CS61B	3/16"	BF-CS62B	3/16"	BF-CS64B
1/4"	BF-PG60C	1/4"	BF-PG61C	1/4"	BF-PG6160C	1/4"	BF-PG62C	1/4"	BF-PG64C
5/16"	BF-PG60D	5/16"	BF-PG61D	5/16"		5/16"	BF-PG62D	5/16"	BF-PG64D
3/8"	BF-PG60E	3/8"	BF-PG61E	3/8"	BF-PG6160E	3/8"	BF-PG62E	3/8"	BF-PG64E
1/2"	BF-PG60F	1/2"	BF-PG61F	1/2"	BF-PG6160F	1/2"	BF-PG62F	1/2"	BF-PG64F



Sleeve (BF-PG60_)



Nut (BF-PG61_)



Nut/Sleeve (BF-PG6160_)



Union (BF-PG62_)



Tee (BF-PG64_)

Size	Male Connector Poly Tube O.D. x Male Pipe	Female Connector Poly Tube O.D. x Female Pipe	Male Elbow Poly Tube O.D. x Male Pipe	Female Elbow Poly Tube O.D. x Female Pipe	Male Branch Tee Poly Tube O.D.x Male Pipe
1/8" x 1/8"	BF-CS68A	BF-CS66A	BF-CS69A	BF-CS70A	BF-CS72A
3/16" x 1/8"	BF-CS68B	BF-CS66B	BF-CS69B	BF-CS70B	BF-CS72B
1/4" x 1/8"	BF-PG68C	BF-PG66C	BF-PG69C	BF-PG70C	BF-PG72C
1/4" x 1/4"	BF-PG68CC	BF-PG66CC	BF-PG69CC	BF-PG70CC	BF-PG72CC
1/4" x 3/8"	BF-PG68CE		BF-PG69CE		
5/16" x 1/8"	BF-PG68D	BF-PG66D	BF-PG69D		BF-PG72D
5/16" x 1/4"	BF-PG68DD	BF-PG66DD			
3/8" x 1/8"	BF-PG68E	BF-PG66E	BF-PG69E		BF-PG72E
3/8" x 1/4"	BF-PG68EE	BF-PG66EE	BF-PG69EE	BF-PG70EE	BF-PG72EE
3/8" x 3/8"	BF-PG68EEE		BF-PG69EEE		
1/2" x 3/8"	BF-PG68F	BF-PG66F	BF-PG69F	BF-PG70F	BF-PG72F



Male Connector
(BF-PG68_)



Female Connector
(BF-PG66_)



Male Elbow
(BF-PG69_)



Female Elbow
(BF-PG70_)



Male Branch Tee
(BF-PG70_)

Transmission "Sure-Grip" Fittings (Brass)

Size	Sleeve Tube O.D.	Nut Tube O.D.	Union Tube O.D.	Male Connector Tube O.D. x Male Pipe	Male Elbow Tube O.D.x Male Pipe
1/8"	BF-660A	BF-661A	BF-662A		
1/8" x 1/8"				BF-668A	BF-669A
1/4" x 1/16"				BF-668AS	BF-669AS
5/32"	BF-660AA	BF-661AA	BF-662AA		
5/32" x 1/8"				BF-668AA	BF-669AA
5/32" x 1/16"				BF-668AAS	



Sleeve
(BF-660_)



Nut
(BF-661_)



Union
(BF-662_)



Male Connector
(BF-668_)



Male Elbow
(BF-669_)

D.O.T. Air Brake Fittings, Reuseable (Brass)

Size	Hose Sleeve Hose O.D. x Hose I.D.	Hose Nut Hose O.D. x Hose I.D.	Hose Nut w/ Spring Guard O.D. x I.D.	Spring Guard Hose O.D. x Hose I.D.	Hose Union Hose O.D. x Hose I.D.
3/4" x 3/8"	BF-360J	BF-361J	BF-371J	BF-371SPR-J	BF-362J
7/8" x 1/2"	BF-360M	BF-361M	BF-371M	BF-371SPR-M	BF-362M



Size	Hose Connector w/ Spring Guard O.D. x I.D. x Male Pipe	Hose Connector O.D. x I.D. x Male Pipe	Connector Body Hose O.D. x Hose I.D.	Connector w/ Male Pipe Adapter O.D. x I.D. x Male Pipe	Adapter Body Special Thread x Male Pipe
3/4" x 3/8" x 1/4"	BF-378JC	BF-368JC	BF-368JC-BO	BF-398JC	BF-398JC-BO
3/4" x 3/8" x 3/8"	BF-378JE	BF-368JE	BF-368JE-BO	BF-398JE	BF-398JE-BO
3/4" x 3/8" x 1/2"	BF-378JF	BF-368JF	BF-368JF-BO		
7/8" x 1/2" x 3/8"	BF-378ME	BF-368ME	BF-368ME-BO	BF-398ME	BF-398ME-BO
7/8" x 1/2" x 1/2"	BF-378MF	BF-368MF	BF-368MF-BO		BF-398MF-BO

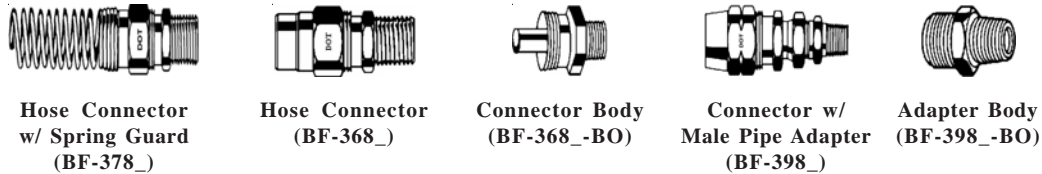

Push Lock Air Brake Fittings (High Strength Composite)

Size	Male Connector	Male Elbow	45° Male Elbow	Union	Union Tee
1/4"	VEL-016144	VEL-016244	VEL-016444	VEL-016640	VEL-016940
3/8"	VEL-016166	VEL-016266	VEL-016466	VEL-016660	VEL-016960
1/2"	VEL-016188	VEL-016288	VEL-016486	VEL-016680	VEL-016980



Push Lock Air Brake Fittings are made of high strength composite which are D.O.T. compliant.

Operating Temperature: -40°F to +200°F

Maximum Operating Pressure: 150 PSI

D.O.T. Push In Fittings (Brass)

Size	Male Connector Tube O.D. x Male Pipe	Male Elbow Tube O.D. x Male Pipe	45° Male Elbow Tube O.D. x Male Pipe	Female Elbow Tube O.D. x Female Pipe	Tee w/ Male Pipe Tube O.D. x Male Pipe	Tee Tube O.D.	Union Tube O.D.
		Swivel: BF-PP69S_	Swivel: BF-PP78S_		Swivel: BF-PP72S_		
1/4"						BF-PP62C-DOT	BF-PP64C-DOT
1/4" x 1/8"	BF-PP68C-DOT	BF-PP69C-DOT	BF-PP78C-DOT	BF-PP70C-DOT	BF-PP72C-DOT		
1/4" x 1/4"	BF-PP68CC-DOT	BF-PP69CC-DOT	BF-PP78CC-DOT	BF-PP70CC-DOT	BF-PP72CC-DOT		
1/4" x 3/8"	BF-PP68CE-DOT	BF-PP69CE-DOT					
3/8"						BF-PP62E-DOT	BF-PP64E-DOT
3/8" x 1/8"	BF-PP68E-DOT	BF-PP69E-DOT	BF-PP78E-DOT				
3/8" x 1/4"	BF-PP68EE-DOT	BF-PP69EE-DOT	BF-PP78EE-DOT	BF-PP70EE-DOT	BF-PP72EE-DOT		
3/8" x 3/8"	BF-PP68EEE-DOT	BF-PP69EEE-DOT	BF-PP78EEE-DOT	BF-PP70EEE-DOT	BF-PP72EEE-DOT		
3/8" x 1/2"	BF-PP68EF-DOT	BF-PP69EF-DOT	BF-PP78EF-DOT				
1/2"						BF-PP62F-DOT	BF-PP64F-DOT
1/2" x 1/4"	BF-PP68FC-DOT	BF-PP69FC-DOT	BF-PP78FC-DOT				
1/2" x 3/8"	BF-PP68F-DOT	BF-PP69F-DOT	BF-PP78F-DOT		BF-PP72F-DOT		
1/2" x 1/2"	BF-PP68FF-DOT	BF-PP69FF-DOT	BF-PP78FF-DOT	BF-PP70FF-DOT			
5/8"						BF-PP62H-DOT	BF-PP64H-DOT
5/8" x 3/8"		BF-PP69HE-DOT					
5/8" x 1/2"	BF-PP68H-DOT	BF-PP69H-DOT	BF-PP78H-DOT				
3/4"						BF-PP62J-DOT	BF-PP64J-DOT
3/4" x 1/2"	BF-PP68J-DOT	BF-PP69J-DOT	BF-PP78J-DOT				
3/4" x 3/4"	BF-PP68JJ-DOT	BF-PP69JJ-DOT	BF-PP78JJ-DOT				



D.O.T. Push In Fittings meet FMVSS 571.106 Air Brake performance specifications.

Fitting Body: Brass

Seals: BUNA-N (Nitrile "O" Rings)

Operating Temperature: -40°F to +200°F

Maximum Operating Pressure: Vacuum to 250 PSI

D.O.T. Air Brake Fittings, for Nylon Tubing (Brass)

Size	Sleeve Tube O.D.	Size	Nut Tube O.D.	Size	S.S. Insert Tube O.D.	Size	Tee Tube O.D.	Size	Union Tube O.D.
3/16"	BF-TH260B	3/16"	BF-TH261B	3/16"	BF-TH461B	3/16"		3/16"	
1/4"	BF-TH260C	1/4"	BF-TH261C	1/4"	BF-TH461C	1/4"	BF-TH264C	1/4"	BF-TH262C
3/8"	BF-TH260E	3/8"	BF-TH261E	3/8"	BF-TH461E	3/8"	BF-TH264E	3/8"	BF-TH262E
1/2"	BF-TH260F	1/2"	BF-TH261F	1/2"	BF-TH461F	1/2"	BF-TH264F	1/2"	BF-TH262F
5/8"	BF-TH260H	5/8"	BF-TH261H	5/8"	BF-TH461H	5/8"	BF-TH264H	5/8"	BF-TH262H
3/4"	BF-TH260J	3/4"	BF-TH261J	3/4"	BF-TH461J	3/4"		3/4"	BF-TH262J



D.O.T. Air Brake Fittings, for Nylon Tubing (Brass)

Size	Male Connector Tube O.D. x Male Pipe	Female Connector Tube O.D. x Female Pipe	Male Elbow Tube O.D. x Male Pipe	45° Male Elbow Tube O.D. x Male Pipe	Female Elbow Tube O.D. x Female Pipe
3/16" x 1/8"	BF-TH268B		BF-TH269B		
3/16" x 1/4"	BF-TH268BB		BF-TH269BB		
1/4" x 1/8"	BF-TH268C	BF-TH266C	BF-TH269C	BF-TH278C	BF-TH270C
1/4" x 1/4"	BF-TH268CC	BF-TH266CC	BF-TH269CC	BF-TH278CC	BF-TH270CC
1/4" x 3/8"	BF-TH268CE		BF-TH269CE		
3/8" x 1/8"	BF-TH268E	BF-TH266E	BF-TH269E	BF-TH278E	BF-TH270E
3/8" x 1/4"	BF-TH268EE	BF-TH266EE	BF-TH269EE	BF-TH278EE	BF-TH270EE
3/8" x 3/8"	BF-TH268EEE	BF-TH266EEE	BF-TH269EEE	BF-TH278EEE	BF-TH270EEE
3/8" x 1/2"	BF-TH268EF		BF-TH269EF	BF-TH278EF	
1/2" x 1/4"	BF-TH268FC		BF-TH269FC		
1/2" x 3/8"	BF-TH268F	BF-TH266F	BF-TH269F	BF-TH278F	BF-TH270F
1/2" x 1/2"	BF-TH268FF	BF-TH266FF	BF-TH269FF	BF-TH278FF	BF-TH270FF
1/2" x 3/4"	BF-TH268FJ				
5/8" x 3/8"	BF-TH268HE	BF-TH266HE	BF-TH269HE		
5/8" x 1/2"	BF-TH268H	BF-TH266H	BF-TH269H	BF-TH278H	BF-TH270H
5/8" x 3/4"	BF-TH268HJ		BF-TH269HJ		
3/4" x 1/2"	BF-TH268J		BF-TH269J	BF-TH278J	
3/4" x 3/4"	BF-TH268JJ		BF-TH269JJ		



Male Connector
(BF-TH268_)



Female Connector
(BF-TH266_)



Male Elbow
(BF-TH269_)



45° Male Elbow
(BF-TH278_)



Female Elbow
(BF-TH270_)

Hydraulic Tube Fittings (J.I.C. 37)

Size	Nut, 3-Pc. Tube O.D.
1/8"	BPC-H5105X2
3/16"	BPC-H5105X3
1/4"	BPC-H5105X4
5/16"	BPC-H5105X5
3/8"	BPC-H5105X6
1/2"	BPC-H5105X8
5/8"	BPC-H5105X10
3/4"	BPC-H5105X12



Size	Cap Tube O.D.
1/8"	BPC-H5129X2
3/16"	BPC-H5129X3
1/4"	BPC-H5129X4
5/16"	BPC-H5129X5
3/8"	BPC-H5129X6
1/2"	BPC-H5129X8
5/8"	BPC-H5129X10
3/4"	BPC-H5129X12



Size	Sleeve, 3-Pc. Tube O.D.
1/8"	BPC-H5165X2
3/16"	BPC-H5165X3
1/4"	BPC-H5165X4
5/16"	BPC-H5165X5
3/8"	BPC-H5165X6
1/2"	BPC-H5165X8
5/8"	BPC-H5165X10
3/4"	BPC-H5165X12



Size	Plug Tube O.D.
1/8"	
3/16"	
1/4"	BPC-H5229X4
5/16"	BPC-H5229X5
3/8"	BPC-H5229X6
1/2"	BPC-H5229X8
5/8"	BPC-H5229X10
3/4"	BPC-H5229X12



Size	Large Hex Union Tube O.D.
1/8"	
3/16"	
1/4"	BPC-H5306X4
5/16"	
3/8"	BPC-H5306X6
1/2"	BPC-H5306X8
5/8"	BPC-H5306X10
3/4"	BPC-H5306X12



Size	Bulkhead Union Tube O.D.
1/8"	
3/16"	
1/4"	BPC-H5325X4
5/16"	
3/8"	BPC-H5325X6
1/2"	BPC-H5325X8
5/8"	BPC-H5325X10
3/4"	BPC-H5325X12



Size	Male Connector Tube O.D. x Pipe Thread
1/8" x 1/8"	BPC-H5205X2
3/16" x 1/8"	BPC-H5205X3
1/4" x 1/8"	BPC-H5205X4
1/4" x 1/4"	BPC-H5205X4X4
1/4" x 3/8"	BPC-H5205X4X6
1/4" x 1/2"	BPC-H5205X4X8
5/16" x 1/8"	BPC-H5205X5
5/16" x 1/4"	BPC-H5205X5X4
5/16" x 3/8"	BPC-H5205X5X6
3/8" x 1/8"	BPC-H5205X6X2
3/8" x 1/4"	BPC-H5205X6
3/8" x 3/8"	BPC-H5205X6X6
3/8" x 1/2"	BPC-H5205X6X8
1/2" x 3/8"	BPC-H5205X8
1/2" x 1/4"	BPC-H5205X8X4
1/2" x 1/2"	BPC-H5205X8X8
1/2" x 3/4"	BPC-H5205X8X12
5/8" x 3/8"	BPC-H5205X10X6
5/8" x 1/2"	BPC-H5205X10
5/8" x 3/4"	BPC-H5205X10X12
3/4" x 1/2"	BPC-H5205X12X8
3/4" x 3/4"	BPC-H5205X12



Size	45° Male Elbow Tube O.D. x Pipe Thread
1/8" x 1/8"	BPC-H5355X2
3/16" x 1/8"	BPC-H5355X3
1/4" x 1/8"	BPC-H5355X4
1/4" x 1/4"	BPC-H5355X4X4
1/4" x 3/8"	
1/4" x 1/2"	
5/16" x 1/8"	BPC-H5355X5
5/16" x 1/4"	BPC-H5355X5X4
5/16" x 3/8"	
3/8" x 1/8"	BPC-H5355X6X2
3/8" x 1/4"	BPC-H5355X6
3/8" x 3/8"	BPC-H5355X6X6
3/8" x 1/2"	BPC-H5355X6X8
1/2" x 3/8"	BPC-H5355X8
1/2" x 1/4"	BPC-H5355X8X4
1/2" x 1/2"	BPC-H5355X8X8
1/2" x 3/4"	
5/8" x 3/8"	BPC-H5355X10X6
5/8" x 1/2"	BPC-H5355X10
5/8" x 3/4"	
3/4" x 1/2"	BPC-H5355X12X8
3/4" x 3/4"	BPC-H5355X12



Size	90° Male Elbow Tube O.D. x Pipe Thread
1/8" x 1/8"	BPC-H5405X2
3/16" x 1/8"	BPC-H5405X3
1/4" x 1/8"	BPC-H5405X4
1/4" x 1/4"	BPC-H5405X4X4
5/16" x 1/8"	BPC-H5405X5
5/16" x 1/4"	BPC-H5405X5X4
3/8" x 1/8"	BPC-H5405X6X2
3/8" x 1/4"	BPC-H5405X6
3/8" x 3/8"	BPC-H5405X6X6
3/8" x 1/2"	BPC-H5405X6X8
1/2" x 3/8"	BPC-H5405X8
1/2" x 1/4"	BPC-H5405X8X4
1/2" x 1/2"	BPC-H5405X8X8
1/2" x 3/4"	BPC-H5405X8X12
5/8" x 3/8"	BPC-H5405X10X6
5/8" x 1/2"	BPC-H5405X10
5/8" x 3/4"	BPC-H5405X10X12
3/4" x 1/2"	BPC-H5405X12X8
3/4" x 3/4"	BPC-H5405X12



Size	90° Female Elbow Tube O.D. x Pipe Thread
1/4" x 1/8"	BPC-H5455X4
1/4" x 1/4"	BPC-H5455X4X4
5/16" x 1/8"	BPC-H5455X5
3/8" x 1/8"	BPC-H5455X6X2
3/8" x 1/4"	BPC-H5455X6
3/8" x 3/8"	BPC-H5455X6X6
1/2" x 3/8"	BPC-H5455X8
1/2" x 1/2"	BPC-H5455X8X8
5/8" x 1/2"	BPC-H5455X10
3/4" x 3/4"	BPC-H5455X12



Size	Small Hex Union Tube OD x Tube OD
1/8" x 1/8"	BPC-H5305X2
3/16" x 3/16"	BPC-H5305X4
1/4" x 1/4"	BPC-H5305X4X4
5/16" x 5/16"	BPC-H5305X5
3/8" x 1/4"	BPC-H5305X6
3/8" x 3/8"	BPC-H5305X6X6
1/2" x 3/8"	BPC-H5305X8
1/2" x 1/2"	BPC-H5305X8X8
5/8" x 5/8"	BPC-H5305X10
3/4" x 1/2"	BPC-H5305X12X8
3/4" x 3/4"	BPC-H5305X12



Size	Rigid Female Pipe to Male JIC
1/8" x 1/8"	BPC-H5255X2
1/4" x 1/8"	BPC-H5255X4
1/4" x 1/4"	BPC-H5255X4X4
5/16" x 1/8"	BPC-H5255X5
5/16" x 1/4"	BPC-H5255X5X4
3/8" x 1/4"	BPC-H5255X6
3/8" x 3/8"	BPC-H5255X6X6
1/2" x 3/8"	BPC-H5255X8
1/2" x 1/2"	BPC-H5255X8X8
5/8" x 1/2"	BPC-H5255X10
3/4" x 1/2"	BPC-H5255X12X8
3/4" x 3/4"	BPC-H5255X12



Tube Fittings, J.I.C. 37

Typical applications include hydraulic, instrumentation and chemical processing systems.

Pressure: Up to 10,000 PSI depending on tube size.

Sealing Method: 3-Piece flare.

Used With: Copper, Brass, Steel, Aluminum, and other tubing that can be flared.

Conformance: Meets J.I.C. SAE (J154) standards

* More JIC type fittings are available upon request. Please call for more information.

SERIES U2

Size	1/4" Body Size		
	Female Thread NPSF	Male Thread NPTF	Hose Stem Hose I.D.
1/4'	TP-U2-16	TP-U2-15	TP-U2-17
3/8"	TP-U3-21		TP-U2-22

Universal couplers are designed to exhaust air pressure prior to disconnection to prevent hose whip. The six ball locking system resists wear and provides positive connection.

These universal couplers interchange with:

- 1/4" or 3/8" Industrial interchange
- 1/4" or 3/8" ARO 210
- 1/4" or 3/8" Parker Truflate 10 Series
- 1/4" Lincoln

* Although the Universal Coupler permits multiple series plugs to mate with one coupler, it is recommended to match like series couplers and plugs. When using a Universal Coupler, the lower performance rating between the coupler and plug must take precedence. Please contact for technical data.



Industrial Interchange, Single Shut-Off Couplers & Plugs (1/4" Basic Size)

Size (NPTF)	Plug		Automatic Coupler		Manual Coupler		High Performance Manual Coupler w/ Locking Balls	
	Female Thread	Male Thread	Female Thread	Male Thread	Female Thread	Male Thread	Female Thread	Male Thread
1/8"	TP-1803	TP-1802	TP-183	TP-180	TP-M183	TP-M180	TP-A183	TP-A180
1/4'	TP-1805	TP-1804	TP-184	TP-181	TP-M184	TP-M181	TP-A184	TP-A181
3/8"	TP-1807	TP-1806	TP-185	TP-182	TP-M185	TP-M182	TP-A185	TP-A182

Industrial Interchange, Single Shut-Off Couplers & Plugs (3/8" Basic Size)

Size (NPTF)	Plug		Automatic Coupler		Manual Coupler		High Performance Manual Coupler w/ Locking Balls	
	Female Thread	Male Thread	Female Thread	Male Thread	Female Thread	Male Thread	Female Thread	Male Thread
1/4'	TP-T41	TP-T40	TP-T4000	TP-T4100	TP-T400	TP-T410	TP-PT400	TP-PT410
3/8"	TP-T43	TP-T42	TP-T4200	TP-T4300	TP-T420	TP-T430	TP-PT420	TP-PT430
1/2"	TP-T45	TP-T44	TP-T4400	TP-T4500	TP-T440	TP-T450	TP-PT440	TP-PT440

Industrial Interchange, Single Shut-Off Couplers & Plugs (1/2" Basic Size)

Size (NPTF)	Plug		Automatic Coupler		Manual Coupler	
	Female Thread	Male Thread	Female Thread	Male Thread	Female Thread	Male Thread
3/8"	TP-T53	TP-T52	TP-T5000	TP-T5100	TP-T500	TP-T510
1/2'	TP-T55	TP-T54	TP-T5200	TP-T5300	TP-T520	TP-T530
3/4"	TP-T57	TP-T56	TP-T5400	TP-T5500	TP-T540	TP-T550



Plug



Automatic Coupler



Manual Coupler



H.P. Manual Coupler

Industrial Interchange Couplers and Plugs provide convenient automatic one-handed connection and safe disconnection. Couplers have a reverse-acting sleeve to prevent accidental disconnection and prevent whip during disconnection.

Parker Truflate Interchange, Single Shut-Off Couplers & Plugs (1/4" Basic Size)

Size (NPTF)	Plug		Automatic Coupler		High Performance Manual Coupler w/ Locking Balls	
	Female Thread	Male Thread	Female Thread	Male Thread	Female Thread	Male Thread
1/8"	TP-2153	TP-2152	TP-2183	TP-2180	TP-A2183	TP-A2180
1/4"	TP-2155	TP-2154	TP-2184	TP-2181	TP-A2184	TP-A2181
3/8"	TP-2157	TP-2156	TP-2185	TP-2182	TP-A2185	TP-A2182

Parker Truflate Interchange, Single Shut-Off Couplers & Plugs (3/8" Basic Size)

Size (NPTF)	Plug		Manual Coupler	
	Female Thread	Male Thread	Female Thread	Male Thread
1/4"	TP-PT41	TP-PT40	TP-PT400	TP-PT410
3/8"	TP-PT43	TP-PT42	TP-PT420	TP-PT430
1/2"			TP-PT440	TP-PT450



Plug



Automatic Coupler



H.P. Manual Coupler

Lincoln Interchange, Single Shut-Off Couplers & Plugs (1/4" Basic Size)

Size (NPTF)	Plug		Automatic Coupler	
	Female Thread	Male Thread	Female Thread	Male Thread
1/8"		TP-1106		TP-1102
1/4"	TP-1110	TP-1109	TP-1100	TP-1101



Plug



Automatic Coupler

Industrial Interchange, Double Shut-Off Couplers & Plugs (Flush Face)

Size	Female Thread	Plug	Coupler
1/4"	1/4" NPTF	TP-EP2-16	TP-EC2-16
3/8"	3/4"-16 UNF	TP-EP3-8	TP-EC3-8
	3/8" NPTF	TP-EP3-21	TP-EC3-21
	1/2" NPTF	TP-EP3-26	TP-EC3-26
1/2"	1-1/16"-12 UN	TP-EP4-12	TP-EC4-12
	1/2" NPTF	TP-EP4-24	TP-EC4-24
	3/4" NPTF	TP-EP4-31	TP-EC4-31
3/4"	3/4" NPTF	TP-EP6-31	TP-EC6-31
1"	1" NPTF	TP-EP8-36	TP-EC8-36

SERIES FE



Plug



Coupler

Flush Face Double Shut-Off Couplers and Plugs are ISO 16028
 Patented coupler-stem retention system provides optimum performance during surge flow, burst, and impulse pressure. Heavy duty grooved sleeves are highly versatile, rugged, and ideal for bulkhead mounting. * Please call for technical data.

Pioneer Series Interchange, Double Shut-Off Hydraulic Couplers & Plugs

Size	Female Thread	Plug	Coupler
1/4"	1/4" NPTF	TP-P2-16	TP-C2-16
3/8"	3/8" NPTF	TP-P3-21	TP-C3-21
1/2"	3/4"-16 UNF	TP-P4-8	TP-C4-8
	7/8"-14 UNF	TP-P4-10	TP-C4-10
	1/2" NPTF	TP-P4-26	TP-C4-26
	3/4" NPTF	TP-P4-31	TP-C4-31
3/4"	3/4" NPTF	TP-P6-31	TP-C6-31
1"	1" NPTF	TP-P8-36	TP-C8-36

SERIES PC



Plug



Coupler

General Purpose Hydraulic Double Shut-Off Couplers and Plugs are interchangeable with Pioneer 4000 Series.
 Couplers have a poppet style valve to reduce incidents of brinneling during operation. They are ideal for agricultural, construction, forestry, and snow plow applications. * Please call for technical data.

SERIES ST

Body Size		Plug		Coupler	
		Male Pipe	Female Pipe	Male Pipe	Female Pipe
Brass	1/8"	TP-SP1M	TP-SP1	TP-ST1M	TP-ST1
	1/4"	TP-SP2M	TP-SP2	TP-ST2M	TP-ST2
	3/8"	TP-SP3M	TP-SP3	TP-ST3M	TP-ST3
	1/2"	TP-SP4M	TP-SP4	TP-ST4M	TP-ST4
	3/4"	TP-SP6M	TP-SP6	TP-ST6M	TP-ST6
	1"	TP-SP8M	TP-SP8	TP-ST8M	TP-ST8
Stainless Steel	1/8"	TP-SP1M-303	TP-SP1-303	TP-ST1M-303	TP-ST1-303
	1/4"	TP-SP2M-303	TP-SP2-303	TP-ST2M-303	TP-ST2-303
	3/8"	TP-SP3M-303	TP-SP3-303	TP-ST3M-303	TP-ST3-303
	1/2"	TP-SP4M-303	TP-SP4-303	TP-ST4M-303	TP-ST4-303
Steel	1/8"	TP-SP1M-S	TP-SP1-S		
	1/4"	TP-SP2M-S	TP-SP2-S		
	3/8"	TP-SP3M-S	TP-SP3-S		
	1/2"	TP-SP4M-S	TP-SP4-S		
	3/4"	TP-SP6M-S	TP-SP6-S		
	1"	TP-SP8M-S	TP-SP8-S		



Plug



Coupler

Straight Through Couplers are non-valved and are usually applied in liquid systems needing maximum flow with no restrictions. Some typical applications are in chemical processing, pressure wash, plastic mold coolant lines, water manifolds, food processing, and other liquid handling applications where shut-offs are not needed and full flow is needed. * Please call for technical data.

Air Tool Swivels

360° Block Style			
Inlet	Outlet	Material	Part No.
1/4" FNPT	1/4" MNPT	Aluminum	LC-A9700
3/8" FNPT	3/8" MNPT		LC-A9701
1/2" FNPT	1/2" MNPT		LC-A9702



Elbow Swivel			
Inlet	Outlet	Material	Part No.
1/4" FNPT	1/4" Hose Barb	Chrome-Plated Steel	LC-A1441SE
1/4" FNPT	1/4" FNPT		LC-A1445FSE
1/4" MNPT	1/4" MNPT		LC-A1445MSE
1/4" MNPT	1/4" FNPT		LC-A1445MFSE
1/4" MNPT	ARO Plug		LC-A71440SE
1/4" MNPT	Industrial Plug		LC-A73440SE



Ball Swivels			
Inlet	Barb Size	Material	Part No.
1/4" MNPT	1/4"	Chrome-Plated Steel	LC-A1440BS
1/4" FNPT	1/4"		LC-A1441BS
1/4" MNPT	3/8"		LC-A1640BS
1/4" FNPT	3/8"		LC-A1641BS



Units swivel between tool and air supply to reduce equipment wear and prevent fatigue. Elbow swivels have two ball joints for greater flexibility.

Grease Fittings

1/8" Grease Fittings		
Type	Length	Part No.
Straight	.62"	GF-1610
	1-1/4"	GF-1607
	1.75"	GF-1669
30°	.91"	GF-1611
45°	.89"	GF-1688
65°	.84"	GF-1612
90°	.84"	GF-1613

1/4" Grease Fittings		
Type	Length	Part No.
Straight	.55"	GF-1641
	.97"	GF-1680
45°	.81"	GF-1637
90°	.75"	GF-1911
1/4" PTF Straight	.89"	GF-1627
1/4" PTF 90°	.88"	GF-1629

Drive Type Grease Fittings		
Size	Length	Part No.
3/16"	.55"	GF-1728
1/4"	.55"	GF-1743
5/16"	.55"	GF-1699
5/16"-24	.66"	GF-1711
3/8"-24	.62"	GF-1710

Grease Fitting Caps	
Color	Part No.
Blue	GF-CAP-BLUE
Green	GF-CAP-GRN
Red	GF-CAP-RED
White	GF-CAP-WHT
Yellow	GF-CAP-YEL

Metric Grease Fittings			
Size	Straight	45°	90°
6mm	GF-8600	GF-8645	GF-8690
8mm	GF-8800	GF-8845	GF-8890
10mm	GF-8100	GF-8104	GF-8109



Hose Whips and 4-Jaw Couplers

Hose Whips for use with all types of hydraulic grease fittings. Black nitrile, oil resistant tube and neoprene cover has a working pressure of 3,000 Lbs.

GF-12HW 12" Hose Whip, 1/8" NPT
GF-18HW 18" Hose Whip, 1/8" NPT



4-Jaw Universal Coupler forms safe grip on grease fittings. Safely handles pressures up to 20,000 PSI. Resists leakage and maintains a positive seal at all times.

GF-4JC 1/8" NPT



EL-Cor offers a complete line of Hose Reel, Air Line, and Liquid Flow products and accessories from:

- | | | | |
|-----------|------------|---------------|-----------|
| Cox Reels | Reel Craft | Legacy | Velvac |
| Tectran | Milton | Plew/Edelmann | Tru-Flate |
| | | | Seal Fast |

Other Available Products Such As:

- Self-Locking Couplers
- Fuel Tanker Products
- Universal Crowfoot Couplings
- Hose Ferrules
- Hydraulic Hose Couplings (37 JIC)
- Air, Drain, Oil Tank, Needle, and Shut-Off Valves
- Braided Hose
- Suction Hose
- Chemical Hose
- Water Discharge Hose
- PVC Suction Hose
- Mill Cloth Hose

* Please call for product information.

Cam and Groove Couplings (Aluminum)

Size	Female NPT x Male Adapter	Female Coupler x Male NPT	Female Coupler x Hose Shank	Female Coupler x Female NPT	Male Adapter x Hose Shank	Male Adapter x Male NPT
1"	ARC-QA-100-DC	ARC-QB-100-DC	ARC-QC-100-DC	ARC-QD-100-DC	ARC-QE-100-DC	ARC-QF-100-DC
1-1/2"	ARC-QA-150-DC	ARC-QB-150-DC	ARC-QC-150-DC	ARC-QD-150-DC	ARC-QE-150-DC	ARC-QF-150-DC
2"	ARC-QA-200-DC	ARC-QB-200-DC	ARC-QC-200-DC	ARC-QD-200-DC	ARC-QE-200-DC	ARC-QF-200-DC
2-1/2"	ARC-QA-250-DC	ARC-QB-250-DC	ARC-QC-250-DC	ARC-QD-250-DC	ARC-QE-250-DC	ARC-QF-250-DC
3"	ARC-QA-300-DC	ARC-QB-300-DC	ARC-QC-300-DC	ARC-QD-300-DC	ARC-QE-300-DC	ARC-QF-300-DC
4"	ARC-QA-400-DC	ARC-QB-400-DC	ARC-QC-400-DC	ARC-QD-400-DC	ARC-QE-400-DC	ARC-QF-400-DC
* Please call for larger available sizes						

* Also available in Brass, Stainless Steel, Self-Locking.

** Dust Cap Couplers and Dust Plug Adapters available as well.

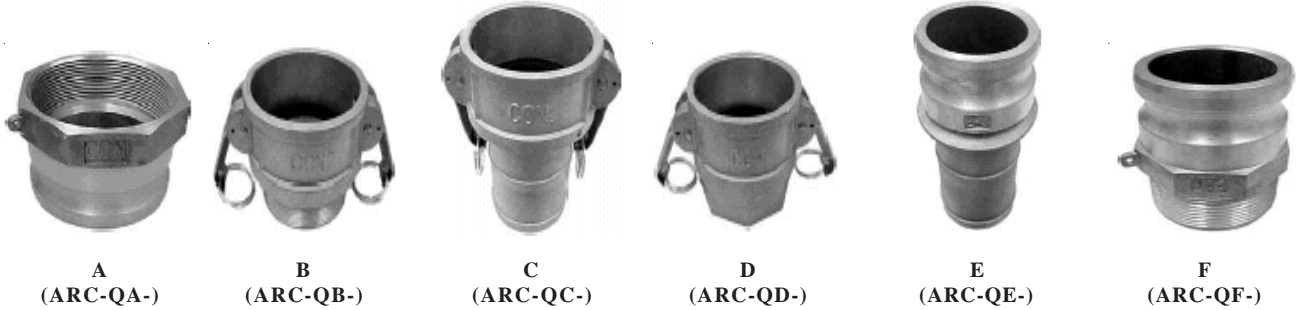

Universal Crowfoot Couplings

Size	Hose End	Female N.P.T. Ends	Male N.P.T. Ends
1/4"	ARC-UH-025-M	ARC-UF-025-M	ARC-UM-025-M
3/8"	ARC-UH-038-M	ARC-UF-038-M	ARC-UM-038-M
1/2"	ARC-UH-050-M	ARC-UF-050-M	ARC-UM-050-M
3/4"	ARC-UH-075-M	ARC-UF-075-M	ARC-UM-075-M
1"	ARC-UH-100-M	ARC-UF-100-M	ARC-UM-100-M
* Brass and Stainless Steel 316 also available upon request			



Other Available Products Such As:

- Four Lug Universal Hose Couplings
- Shank Couplings
- Replacement Washers for Shank Couplings
- Teflon Tape and Pipe Thread Sealant (See Shop & Safety Supplies Quick Reference Catalog)

* Please call for product information.

A large selection of valves for a variety of industrial applications is available.

We offer full port, forged brass ball valves, low pressure, low lead, hose end valves, gate stop & waste valves, gas, check valves, and specialty valves. Whether for water, oil, or gas, hot or cold water application, the valve product line provides a good selection of temperature ranges and operating functions. Most of the valve product line is available in 1/2" to 2" fitting sizes.

* Please contact for more information regarding our line of valves.

Ball Valves, Full Port Forged Brass (600 PSI)

Size	Port Size	CV Rating	Threaded Ends
1/2"	.571	14	BV-500
3/4"	.748	27	BV-750
1"	.945	39	BV-1000
1-1/4"	1.240	70	BV-1250
1-1/2"	1.496	100	BV-1500
2"	1.850	198	BV-2000



Full Port, Forged Brass Ball Valves meets NSF approved low lead standards.

Features dacromet handle and hollow ball.

Threaded ends comply with ANSI B1.20.1

-20° to 300° F temperature range.

* Solder ends available upon request.

Air Tank Drain Cocks

1/4" MPT Air Drain Cocks

VEL-036003 Lever Handle

VEL-036019 Back Seating

VEL-036021 Wing Handle



Brass Air Cocks

Female pipe thread tee handle air cocks.

100 PSI max for air use only.

BF-331TA 1/8" Female Pipe

BF-331TC 1/4" Female Pipe

BF-331TE 3/8" Female Pipe

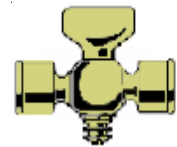

Fuel Line Hose

Inside Diameter	Spool Length	Part No.
1/4"	25 ft.	AGF-1425
	50 ft.	AGF-1450
5/16"	25 ft.	AGF-5625
	50 ft.	AGF-5650
3/8"	25 ft.	AGF-3825
	50 ft.	AGF-3850



Designed for conveying most modern fuels in cars, trucks, buses, etc.

Handles temperature ranges of -40° to +212° F. Withstands oil, grease, abrasion, and exceeds the burst requirements of the SAE30R6 specification. Made of black nitrile with two spiral polyester reinforcement.

Windshield Wiper & Vacuum Tubing

Inside Diameter	Fits	Spool Length	Part No.
7/64"	1/8" Nipple	50 ft.	AGV-76450
5/32"	3/16" Nipple	50 ft.	AGV-53250
7/32"	1/4" Nipple	50 ft.	AGV-73250
9/32"	5/16" Nipple	50 ft.	AGV-93250



Low pressure EPDM tubing for windshield washers, vacuum and emissions systems for power accessories.

Meets SAE J1037 spec. will not deteriorate from heat or weathering. Maintains flexibility at low temperatures of -40° to +257° F.

Heater Hose

Inside Diameter	Spool Length	Black	Red
1/2"	50 ft.	AGHH-1250B	AGHH-1250R
5/8"	50 ft.	AGHH-5850B	AGHH-5850R
3/4"	50 ft.	AGHH-3450B	AGHH-3450R
1"	50 ft.	AGHH-150B	AGHH-150R



Constructed of EPDM with two spiral polyester reinforcement is a replacement on most cars and light duty trucks.

Black Heater Hose: TH-STD-HH grade is similar to SAE20R3 for normal duty service. -40° to +212° F temp. resistance.

Red Heater Hose: Similar to SAE20R3 class D2, SAE J2387 for higher underhood applications. -40° to +257° F temp. resistance.

Heater Hose Fittings (Steel)

Size	Steel Connector Hose x Male Pipe	Brass Connector Hose O.D. x Male Pipe	Brass Male Elbow Hose I.D. x Male Pipe	Steel Male Elbow Hose I.D. x Male Pipe	Hose Splicer Hose I.D.
1/4" x 1/8"		BF-HE809C	BF-HE816C		
1/4" x 1/4"		BF-HE809CC			
5/16" x 1/8"		BF-HE809C	BF-HE816C		
5/16" x 1/4"		BF-HE809DD	BF-HE816DD		
3/8" x 1/8"		BF-HE809E	BF-HE816E		
3/8" x 1/4"		BF-HE809EE	BF-HE816EE		
3/8" x 3/8"		BF-HE809EEE	BF-HE816EEE		
1/2" x 1/4"		BF-HE809FC			BF-HE222F (1/2")
1/2" x 3/8"		BF-HE809F	BF-HE816F		
5/8" x 3/8"	BF-HE220HE	BF-HE809HE	BF-HE816HE	BF-HE229HE	BF-HE222H (5/8")
5/8" x 1/2"	BF-HE220H	BF-HE809H	BF-HE816H	BF-HE229H	
3/4" x 1/2"	BF-HE220J	BF-HE809J	BF-HE816J		BF-HE222J (3/4")



Bulk Air Brake Hose

Inside Diameter	O.D.	Spool Length	Part No.
3/8"	3/4"	250 ft.	ABH-38250
	3/4"	50 ft.	ABH-38050
1/2"	7/8"	250 ft.	ABH-12250
	7/8"	50 ft.	ABH-12050



Bulk rubber hose for use in making brake chamber hose assemblies to custom lengths.

Can be used with reusable style brass hose ends, and/or fittings designed with portable crimping machine. Meets all SAE J1402 and D.O.T. requirements. Hose is rated to 125 PSI.

Nylon Air Brake Tubing

Size	Standard Spool Length	Part No.	Bulk Spool	Bulk Part No.
1/8"	100 ft.	NTA-125-C BLK	1000 ft.	NTA-125-M BLK
1/4"	100 ft.	NTA-250-C BLK	1000 ft.	NTA-250-M BLK
5/16"	100 ft.	NTA-312-C BLK	500 ft.	NTA-312-D BLK
3/8"	100 ft.	NTA-375-C BLK	500 ft.	NTA-375-D BLK
1/2"	100 ft.	NTA-500-C BLK	500 ft.	NTA-500-D BLK
5/8"	50 ft.	NTA-625-L BLK	250 ft.	NTA-625-D BLK
3/4"	50 ft.	NTA-750-L BLK	250 ft.	NTA-750-D BLK

* For smaller size spools please check for availability



For use with air brake systems only. Not for use with fuel line applications.

Meets SAE J844 specifications and is available in 6 color choices. Tubing has a maximum working pressure of 150 PSI and a temperature rating of -40° to +200° F.

* Standard color is Black, for other colors replace BLK with different color code: Red (RED), Blue (BLUE), Yellow (YEL), Green (GRN), and Orange (ORG)

Copper Tubing

Size	Wall Thickness	Spool Length	Part No.
1/4"	0.30"	25 ft.	VEL-02001-7
3/8"	0.49"	25 ft.	VEL-02003-7
1/2"	0.49"	25 ft..	VEL-02005-7
5/8"	0.49"	25 ft.	VEL-02007-7
3/4"	0.49"	25 ft.	VEL-02009-7



Heavy wall tubing is suitable for air brake applications.

Seamless annealed construction.

* Refrigeration Copper Tubing, Soft Aluminum Tubing, and Steel Brake Tubing is also available upon request.

Multi-Purpose Clear Vinyl Tubing

Clear 75 durometer FDA grade PVC tubing for many applications.

Great for low pressure service this tubing is clear, soft, and flexible. Standard spools are 100 ft. and are available in 1/16" through 1" diameters. * Please call for ordering information.

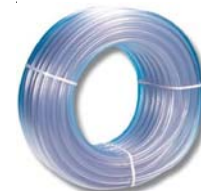

Heavy Duty Air Hose

Size	Spool Length	Part No.
3/8"	25 ft.	AGAH-3825
	50 ft.	AGAH-3850
1/2"	25 ft.	AGAH-1225
	50 ft.	AGAH-1250
* Please inquire for custom length spools		

See page 15-17 for air hose fittings



Designed for tough service station and shop air tool applications.
 Features 4-spiral polyester reinforcement that keeps the hose kink resistant and flexible in extreme temperatures of -40° to +212° F. Comes with fittings and black vinyl guard ends, and is rated to 250 PSI.

Coiled Nylon Tubing Assembly Kits

Length		Part No.
12 Foot Assembly 6" Leads	Standard Kit	AB-12-SET
	Emergency Only (Red)	AB-12-R
	Service Only (Blue)	AB-12-B
15 Foot Assembly 12" Leads	Standard Kit	AB-15-SET
	Emergency Only (Red)	AB-15-R
	Service Only (Blue)	AB-15-B



Includes permanently swaged 1/2"-14 NPTF end fittings with heavy gauge spring for extra support.
 Each standard kit contains one emergency (RED) and one service (BLUE) 1/2" O.D. nylon tubing assembly. Each 12 foot coil has 6" leads, and each 15 foot coil has 12" leads on both ends.

Aluminum Gladhands

Lightweight die cast aluminum bodies meet SAE J318 requirements.
 Clamp plates are color-coded for easy identification, with 1/2" FPT port. Each gladhand includes flat rubber coupling seal.

VEL-035038 Universal Gladhand
VEL-035042 Emergency Gladhand
VEL-035045 Service Gladhand
VEL-035070 Gladhand Grips



Polyurethane Gladhand Seals

Color-Coded seals will not crack or tear, reducing maintenance time and costs associated with rubber seal replacement.

VEL-035009 Red Seal
VEL-035010 Blue Seal
VEL-035011 Black Seal



EL-Cor offers a complete line of Hose Reel, Air Line, and Liquid Flow products and accessories from:

Cox Reels	Reel Craft	Legacy	Velvac	
Tectran	Milton	Plew/Edelmann	Tru-Flate	Seal Fast

* Please call for product information.

Automotive Hose Clamps (Miniature)

Diameter Range		Band Width	Standard Hose Clamp	Stainless Steel Hose Clamp	Box Qty.
Min.	Max.				
7/32"	5/8"	5/16"	HC-M4	HCSS-M4	10
7/16"	25/32"	5/16"	HC-M6	HCSS-M6	10
1/2"	29/32"	5/16"	HC-M8	HCSS-M8	10
9/16"	1-1/16"	5/16"	HC-M10	HCSS-M10	10

**Lightweight, streamlined configuration hose clamps are perfect for air and fuel lines.**

Slotted 1/4" hex head screw installs with screwdriver, nutdriver, or socket. Higher sealing pressure, only 10 in/lbs. of installation torque generates enough sealing pressure for most automotive applications. Features stainless steel band and housing.

Automotive Hose Clamps (Full Size)

Diameter Range		Band Width	Standard Hose Clamp	Stainless Steel Hose Clamp	Box Qty.
Min.	Max.				
7/16"	25/32"	1/2"	HC-6	HCSS-6	10
1/2"	29/32"	1/2"	HC-8	HCSS-8	10
9/16"	1-1/16"	1/2"	HC-10	HCSS-10	10
11/16"	1-1/4"	1/2"	HC-12	HCSS-12	10
13/16"	1-1/2"	1/2"	HC-16	HCSS-16	10
13/16"	1-3/4"	1/2"	HC-20	HCSS-20	10
1-1/16"	2"	1/2"	HC-24	HCSS-24	10
1-5/16"	2-1/4"	1/2"	HC-28	HCSS-28	10
1-9/16"	2-1/2"	1/2"	HC-32	HCSS-32	10
1-13/16"	2-3/4"	1/2"	HC-36	HCSS-36	10
2-1/16"	3"	1/2"	HC-40	HCSS-40	10
2-5/16"	3-1/4"	1/2"	HC-44	HCSS-44	10
2-9/16"	3-1/2"	1/2"	HC-48	HCSS-48	10
2-13/16"	3-3/4"	1/2"	HC-52	HCSS-52	10
3-1/16"	4"	1/2"	HC-56	HCSS-56	10
3-5/16"	4-1/4"	1/2"	HC-60	HCSS-60	10
3-9/16"	4-1/2"	1/2"	HC-64	HCSS-64	10
1-7/8"	5"	1/2"	HC-72	HCSS-72	10
2-1/2"	5-1/2"	1/2"	HC-80	HCSS-80	10
3-1/8"	6"	1/2"	HC-88	HCSS-88	10
3-5/8"	6-1/2"	1/2"	HC-96	HCSS-96	10
4-1/8"	7"	1/2"	HC-104	HCSS-104	10
5-5/8"	8-1/2"	1/2"	HC-128	HCSS-128	10
7-1/8"	10"	1/2"	HC-152	HCSS-152	10
9-3/8"	12-1/4"	1/2"	HC-188	HCSS-188	10

**Extra long, "Square Knot" interlocked construction won't pull apart.**

Slotted 5/16" hex head screw installs with screwdriver, nutdriver, or socket. Arcial slots and buttressed screw threads for smooth, positive worm gear action will not cause jamming. Smooth underside ensures the most effective seal possible. Features stainless steel band and housing.

Automotive Hose Clamps (Constant Torque)

Diameter Range		Band Width	Constant Torque Hose Clamp	Box Qty.
Min.	Max.			
9/16"	1-1/16"	9/16"	HC-CT9410	10
11/16"	1-1/4"	9/16"	HC-CT9412	10
13/16"	1-1/2"	9/16"	HC-CT9416	10
13/16"	1-3/4"	9/16"	HC-CT9420	10
1-1/16"	2"	9/16"	HC-CT9424	10
1-5/16"	2-1/4"	9/16"	HC-CT9428	10
1-9/16"	2-1/2"	9/16"	HC-CT9432	10
1-13/16"	2-3/4"	9/16"	HC-CT9436	10
2-1/16"	3"	9/16"	HC-CT9440	10
2-5/16"	3-1/4"	9/16"	HC-CT9444	10
2-9/16"	3-1/2"	9/16"	HC-CT9448	10

Automotive Hose Clamps (Constant Torque S.S.) 25

Diameter Range		Band Width	S.S. Heavy Duty Constant Torque	Box Qty.
Min.	Max.			
1-1/4"	2-1/8"	5/8"	HC-CT-200LSS	10
1-3/4"	2-5/8"	5/8"	HC-CT-250LSS	10
2-1/4"	3-1/8"	5/8"	HC-CT-300LSS	10
2-3/4"	3-5/8"	5/8"	HC-CT-350LSS	10
3-1/4"	4-1/8"	5/8"	HC-CT-400LSS	10
3-3/4"	4-5/8"	5/8"	HC-CT-450LSS	10
4-1/4"	5-1/8"	5/8"	HC-CT-500LSS	10

* 410 Stainless Hex Screw



This clamp reacts to changes in hose systems by increasing or decreasing its own diameter as the system expands or contracts. For use when experiencing leakage or rupture problems because of "cold flow" or changes in operational temperatures.

Standard Constant Torque Clamps should be used on small diameter applications. Heavy Duty Constant Torque Clamps should be used on large diameter applications.

Hose Clamps, DIN 3017 (European Style)

Diameter Range		Band Width	Hose Clamp	Box Qty.
Min.	Max.			
5/16"	1/2"	5/16"	HCSS-1W4	10
3/8"	5/8"	5/16"	HCSS-2W4	10
1/2"	3/4"	5/16"	HCSS-4W4	10
5/8"	1"	11/32"	HCSS-8W4	10
3/4"	1-1/4"	11/32"	HCSS-12W4	10
1"	1-5/8"	11/32"	HCSS-18W4	10
1-1/4"	2"	11/32"	HCSS-24W4	10
1-5/8"	2-3/8"	11/32"	HCSS-30W4	10
1-31/32"	2-3/4"	11/32"	HCSS-36W4	10
2-3/8"	3-1/8"	11/32"	HCSS-42W4	10
2-3/4"	3-9/16"	11/32"	HCSS-48W4	10

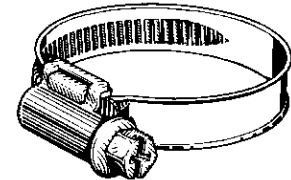

Unique off-set non-welded design of the housing provides resistance to over-tightening damage to the hose. These clamps are original equipment on both domestic and import vehicles.

They are well suited for fuel, vacuum, water, emission, heater hoses, and can be used with silicone hoses. These clamps are DIN3017 with Stainless Steel band and housing.

Fuel Injection Clamps

Diameter Range		Fits Hose I.D.	Constant Torque Hose Clamp	Box Qty.
Min.	Max.			
10.7mm	13.2mm	1/4"	HC-FI-4	10
12.6mm	15.2mm	5/16"	HC-FI-5	10
13.6mm	16.2mm	3/8"	HC-FI-6	10



OEM replacement clamp specified for today's high pressure fuel injection hose.
 Aluzinc plated, rolled edge non-perforated steel band with 6mm slotted, plated steel screw and nut.

Muffler Clamps (Heavy Duty)

Size	Part No.	Box Qty.
1-1/2"	MC-517112	10
1-3/4"	MC-517134	10
1-5/8"	MC-517158	10
1-7/8"	MC-517178	10
2"	MC-517200	10
2-1/8"	MC-517218	10
2-1/4"	MC-517214	10
2-1/2"	MC-517212	10
2-3/4"	MC-517234	10
3"	MC-517300	10
3-1/2"	MC-517312	10
4"	MC-517400	10
5"	MC-517500	10



Other Available Clamps

				
Silicone Liner Clamps	Euro-Style Clamps	Industrial & Aircraft Clamps	T-Bolt Clamps	Spring Loaded T-Bolt Clamps
				
V-Band Clamps	Oetiker Clamps	Punch Type Clamps	Pre-Formed Band Clamps	Clamp Tools

Rubber Coated Tubing Clamps

Clamping Diameter	Mounting Hole	Width	Steel Rubber Coated Clamp	Aluminum Rubber Cushioned Clamp
1/8"	9/32"	1/2"	RBC-18	RBCC-18
3/16"			RBC-36	RBCC-36
1/4"			RBC-14	RBCC-14
5/16"			RBC-56	RBCC-56
3/8"	13/32"	3/4"	RBC-38	RBCC-38
1/2"			RBC-12	RBCC-12
5/8"			RBC-58	RBCC-58
3/4"			RBC-34	RBCC-34
1"			RBC-100	RBCC-100

* Larger Clamp Diameters are Available Upon Request



Rubber Coated



Aluminum Cushioned

Expandable Sleeving

Diameter	Expansion Range		Spool Size	Part No.
	Min.	Max.		
1/8"	1/8"	1/4"	100 ft.	CCPT-187-100
1/4"	5/32"	7/16"	100 ft.	CCPT-250-100
3/8"	3/16"	5/8"	100 ft.	CCPT-375-100
1/2"	1/4"	3/4"	100 ft.	CCPT-500-100
3/4"	5/8"	1"	75 ft.	CCPT-750-75
1"	3/4"	1-3/16"	50 ft.	CCPT-1000-20
1-1/4"	1"	1-1/2"	50 ft.	CCPT-1250-50
1-1/2"	1-1/4"	2"	50 ft.	CCPT-1500-50



Expandable Sleeving is fray-resistant braided sleeving that cuts cleanly with scissor for easy installation.

10 mil. sleeving does not require a hot knife and will not fray when cut with scissors. High abrasion resistance and increased braid density for fuller coverage. For use with -75° C to 125° C temperature range applications. Bulk spool sizes are available.

Heavy Wall Expandable Sleeving

Diameter	Expansion Range		Spool Size	Part No.
	Min.	Max.		
3/8"	3/16"	3/4"	100 ft.	FLEXO-375-100
5/8"	5/16"	1"	75 ft.	FLEXO-625-75
1"	1/2"	1-1/2"	50 ft.	FLEXO-1000-50
1-1/2"	3/4"	2"	50 ft.	FLEXO-1500-50
2"	1-1/2"	3"	50 ft.	FLEXO-2000-50
3"	2"	4"	50 ft.	FLEXO-3000-50
4"	2-1/2"	5-1/2"	50 ft.	FLEXO-4000-50



Heavy Wall Sleeving provides extreme resistance to cuts and abrasion, and expands up to 150% for a wide variety of applications.

15 mil. sleeving easily slips over plugs, connectors, and fittings. It provides extra protection for finished surfaces or from extreme conditions. Resists gasoline, solvents, and chemicals. For use with -75° C to 125° C temperature range applications.

Dura Flex Sleeving

Inside Diameter	Expansion Range	Spool Size	Part No.
.71"	This Product is a non-expandable product. * Be sure to match your application diameter accurately	50 ft..	DFN-071-50
.83"		50 ft.	DFN-083-50
1.00"		50 ft.	DFN-100-50
1.13"		50 ft.	DFN-113-50
1.25"		50 ft.	DFN-125-50
1.34"		50 ft.	DFN-134-50
1.59"		50 ft.	DFN-159-50
1.75"		50 ft.	DFN-175-50
2.07"		50 ft.	DFN-207-50
2.38"		50 ft.	DFN-238-50
2.54"		50 ft.	DFN-254-50
2.86"		50 ft.	DFN-286-50
3.34"		25 ft.	DFN-334-25
3.66"		25 ft.	DFN-366-25



Multiple high pressure hoses can be bundled tightly together to protect them from abrasion and weather.
 Tightly woven .09" nylon resists cuts and abrasion. Prevents damage from UV, gasoline, engine chemicals, and salt. Offers flexible and economical general purpose protection. When installed over uncoated cable or chains, Dura Flex sleeving will prevent scraping, chafing, and contact damage to painted or other fragile surfaces. Cuts with scissor and the tight construction slides easily over any application.
 * Also available in wrap with "Hook and Loop" closure

Stainless Steel Braided Sleeving

Size	Expansion Range		Spool Size	Part No.
	Min.	Max		
1/2"	1/4"	5/8"	100 ft..	SSN-050-100
5/8"	3/8"	3/4"	100 ft..	SSN-063-100
3/4"	1/2"	1"	100 ft..	SSN-075-100
1"	3/4"	1-1/4"	100 ft..	SSN-100-100
1-1/4"	1"	1-1/2"	100 ft..	SSN-125-100
1-3/4"	1-1/2"	2-1/4"	100 ft..	SSN-175-100



Nothing protects hoses from wear and blowout quite like real Stainless Steel braid.
 It looks great in any application and is strong as steel. Take any stock or custom hose, slip a length of FLEXO Stainless over it, hide the cut ends under your clamps and have the same look and protection as custom overbraided hoses at a fraction of the cost. FLEXO Stainless cuts with shears or serrated scissors, is pre-rounded for easy slip on installation and is available in diameters and expansion ranges to accommodate virtually any common hose or wire application.

Fiberglass Braided Sleeving

Size	Max Diameter	Wall Thickness	Spool Size	Black Part No.	Silver Part No.
3/8	5/8"	.043"	50 ft..	FGBS-375-50B	FGBS-375-50S
1/2"	3/4"	.046"	50 ft..	FGBS-500-50B	FGBS-500-50S
5/8"	7/8"	.046"	50 ft..	FGBS-625-50B	FGBS-625-50S
3/4"	1-1/8"	.046"	50 ft..	FGBS-750-50B	FGBS-750-50S
7/8"	1-1/4"	.046"	50 ft..	FGBS-875-50B	FGBS-875-50S
1"	1-5/8"	.057"	25 ft..	FGBS-1000-25B	FGBS-1000-25S

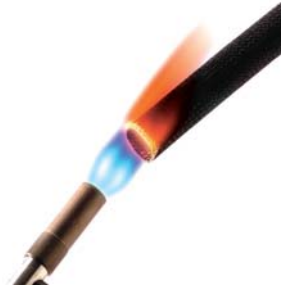

Insultherm is an extremely high temperature resistant sleeve commonly used as a thermal protection for wires, cables, and hoses that are subjected to continuous and extreme high temperature environments, such as engine manifolds and exhaust systems.

Braided from fiberglass yarns and coated with high temperature resins. Tough and durable, maintaining its tight structure under extreme vibration, abrasion, mechanical stress, and temperature variations. Available in a wide range of diameters, it installs over a variety of applications to either deflect or retain heat in environments up to 1,200° F.

Silicone Jacketed Fiberglass Sleeving

Size	Spool Size	Black	Red
3/8"	50 ft.	SJF-038-50B	SJF-038-50R
1/2"	50 ft.	SJF-050-50B	SJF-050-50R
5/8"	50 ft.	SJF-063-50B	SJF-063-50R
3/4"	50 ft.	SJF-075-50B	SJF-075-50R
7/8"	25 ft.	SJF-088-50B	SJF-088-25R
1"	25 ft.	SJF-100-50B	SJF-100-25R
1-1/2"	25 ft.	SJF-150-50B	SJF-150-25R
2"	25 ft.	SJF-200-50B	SJF-200-25R
2-7/8"	25 ft.	SJF-288-50B	SJF-288-25R



Silicone jacketed fiberglass sleeving is the choice of professionals in racing and other industries where protection from constant temperatures approaching 500° F is mandatory.

Engineered to contain radiant exhaust and coolant heat within pipes and hoses and to protect expensive performance equipment and operators from thermal damage. The thick, high temperature fiberglass sleeve is jacketed with a non-permeable heavy silicone coating that is flexible enough to allow tight radius curves, resists all automotive chemicals and solvents. Provides a substantial level of abrasion and puncture protection. Completely non-conductive and will not melt.

EL-Cor offers a complete line of hose protection products. Please call for a complete catalog of Techflex products or for any sample requests.

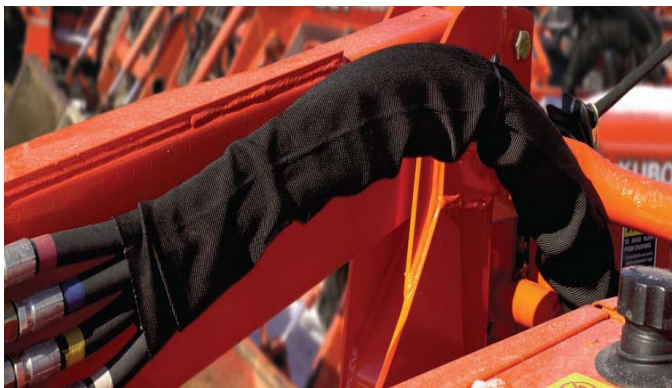



EL-Cor Industries Inc.

www.elcorindustries.com

Phone (847) 465-7400 Fax (847) 465-9802

Located at the southeast corner of Palatine and Wolf Road. Accross from the Chicago Executive Airport.

From Route 53

Head East on Palatine Road.
Exit Wolf Road.
Continue straight on Frontage Road. Crossing over Wolf Road.
Turn right at 15 East Palatine Road. (Between Wolf and Pinecrest Drive)
Our office door faces Palatine Road on the North side of the building.

From Milwaukee Ave.

Head West on Palatine Road.
Exit Wolf Road.
Turn left making a U-turn heading back East onto Frontage Road.
Turn right at 15 East Palatine Road. (Between Wolf and Pinecrest Drive)

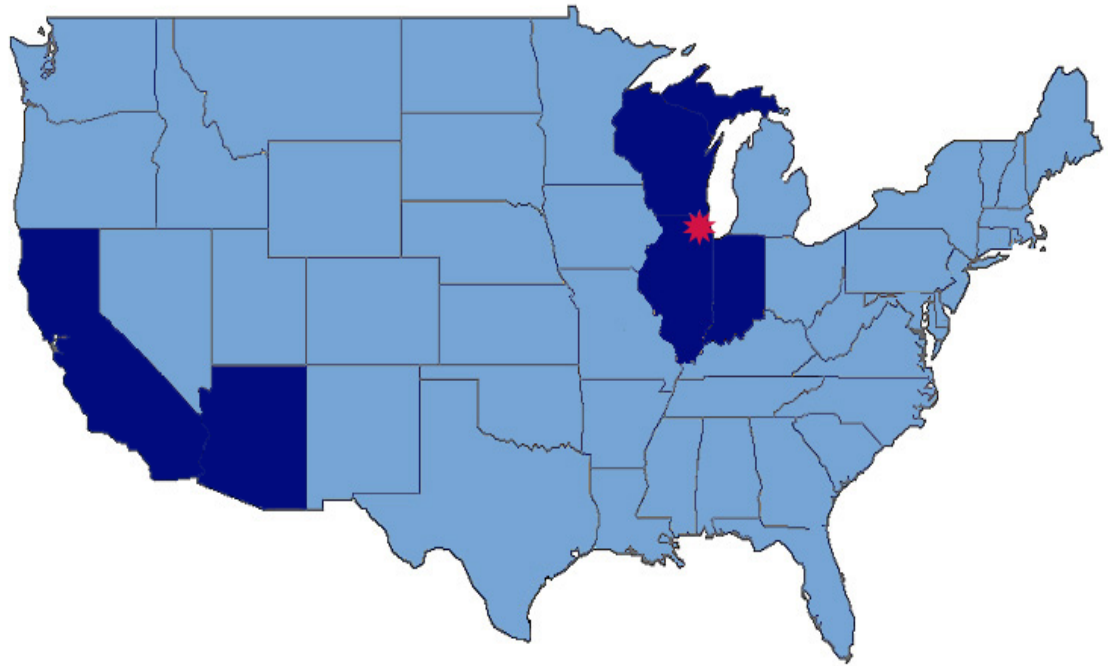

Sales Representatives



Inside Sales



Main Office

Thank you for your interest in our company, we look foward to helping you.
Please call our toll free number for any questions, or to receive any product information.
Visit our webstie to view all of our current specials, and check out new product information.

Toll Free Number: **(888) 465-7400**
Website: www.elcorindustries.com